

price list



www.polypipcivils.co.uk

Effective 1st July 2006



INTRODUCTION

Polypipe Civils Limited is firmly established as the UK's leading supplier of ducting, drainage and environmental systems to the utilities, construction, civil engineering and agricultural industries.

Our highest priority is the innovation and development of new and existing products with a continued dedication to the highest standards of quality and customer service. Large research and development and technical support teams have been put in place to support the launch of an ever increasing number of new products to the industry.

IMPORTANT CHANGES FROM CAP21

With effect from CAP22, price increases on all products effective from 1st July 2006.

The delivery estimates given in the price list are for guidance only. For exact delivery dates, please confirm with our Sales Department at the time of order.

As part of our ongoing product review, some of our slower moving items may have been removed from the price list. Please contact our Sales Department if you have an enquiry for a product which is no longer listed.

TABLE OF CONTENTS

SEWERAGE SYSTEMS

Gravity Systems	Ridgisewer	11
	Ridgitite Saddle	13
	Polysewer	15

SURFACE WATER DRAINAGE

Carrier	Ridgidrain Advanced Drainage System	1
	Ridgigully and Accessories	7
	Ridgisewer	11
Filter	Ridgidrain Advanced Drainage System	1
	Fin & Narrow Filter Drains	10
	Fieldcoil & Landcoil	30
	Ridgitite Saddle	13

AGRICULTURAL PRODUCTS

Land Drainage	Agritwin Pipe	34
	Fieldcoil	30
	Landcoil	31
Miscellaneous	Polydry	32

ANCILLARY PRODUCTS

Lubricant	10
High Visibility Fencing	33
Cable Guards	33
Service Protection Markers	33

DUCTING SYSTEMS

Ridgiduct	Important notes	17
	Electric Cable Duct	17
	Motorway Comms Duct	17
	Comtite Duct Transit System	19
	Orange Lighting	19
	Utility Ducting	19
	Scottish Street Lighting	20
	Fittings	20
Polyduct	Electric Cable Duct	21
	Orange Lighting	22
Ridgicoil	Black Electric Cable Duct	22
	Purple Motorway Comms Duct	22
	Orange Lighting	23
	Utilities	23
	Fittings	24
uPVC	uPVC Specification Ducting	24
	uPVC General Purpose Ducting	25
	Suretwin Twin Wall Ducting	26
	Yellow Perforated Gas Duct	26
	uPVC Utility / Cable TV Ducting	27
	Duct Repair Kit	28
	Hockey Sticks	28
	Ducted Access Systems	28

ENVIRONMENTAL PRODUCTS

Eco-Vat Rainwater Harvesting Systems	34
Polystorm System	9
Stormcheck Chambers	9

RIDGIDRAIN ADVANCED DRAINAGE SYSTEM

ESTIMATOR'S GUIDE

Plain Ended Carrier Drain in 6 metre lengths

Nominal Size (mm)	Price per metre
100	4.51
150	7.58
225	18.59
300	29.54
375	61.10
1050	425.90

Includes one coupling and 2 seals.

Plain Ended Filter Drain in 6 metre lengths

Nominal Size (mm)	Fully perforated Price per metre	Half-perforated Price per metre
100	4.46	4.88
150	7.31	8.22
225	18.25	20.21
300	29.20	32.09
375	60.78	66.50
1050	424.47	-

Includes one coupling for fully perforated pipe and one coupling and 2 seals for half-perforated pipe where seals are specified.

For half-perforated pipes where seals are not specified the fully perforated price should be used.

Integrally Socketed Carrier Drain

Nominal Size (mm)	Length (m)	Price per metre
400	6	74.12
450	6	79.84
500	6	95.71
600	6	126.20
750	3	175.39
900	3	295.17

Includes integral coupling and one seal.

Integrally Socketed Filter Drain

Nominal Size (mm)	Length (m)	Fully perforated Price per metre	Half-perforated Price per metre
400	6	78.59	81.49
450	6	81.21	84.42
500	6	95.70	101.13
600	6	125.30	133.30
750	3	164.30	187.63
900	3	284.44	315.56

Includes integral coupling for fully perforated pipe and integral coupling and one seal for half-perforated pipe where seals are specified.

For half-perforated pipes where seals are not specified the fully perforated price should be used.

Ridgidrain Pack Quantities

Nominal Size (mm)	Quantity
100	85
150	36
225	14
300	9
375	5
400	5
450	1
500	1
600	1
750	1
900	1
1050	1

Pipes, couplings and seals will be invoiced separately.



RIDGIDRAIN ADVANCED DRAINAGE SYSTEM

Plain Ended Carrier Drain in 6 metre lengths

Description	Nom. Size	ID(mm)	OD(mm)	Code	Pack quantity	Price per length	Price per metre
HDPE Carrier Drain Order Seals and Couplings separately if required.	100	100	118	RD100X6PE	85	21.60	3.60
	150	150	178	RD150X6PE	36	34.39	5.73
	225	225	266	RD225X6PE	14	88.07	14.68
	300	300	354	RD300X6PE	9	138.41	23.07
	375	375	435	RD375X6PE	5	293.52	48.92
Polypropylene Carrier Drain Order Seals and Couplings separately if required.	400*	400	460	RD400X6PE	5	P.O.A	
	450*	450	514	RD450X6PE	1	P.O.A	
	500*	500	571	RD500X6PE	1	P.O.A	
	600*	592	675	RD600X6PE	1	P.O.A	
	750*	766	883	RD750X6PE	1	P.O.A	
	900*	914	1040	RD900X6PE	1	P.O.A	
	1050*	1065	1215	RD1050X6PE	1	2007.39	334.57



150 to 900mm



100 to 900mm



Plain Ended Filter Drain in 6 metre lengths

Description	Nom. Size	ID(mm)	OD(mm)	Code	Pack quantity	Price per length	Price per metre
HDPE Filter Drain State fully or half-perforated as required and adjust codes as noted. P = Perforated HP = Half-Perforated	100	100	118	RD100X6PE P or HP*	85	23.83	3.97
	150	150	178	RD150X6PE P or HP*	36	38.19	6.37
	225	225	266	RD225X6PE P or HP*	14	97.77	16.30
	300	300	354	RD300X6PE P or HP*	9	153.71	25.62
	375	375	435	RD375X6PE P or HP*	5	325.93	54.32
Polypropylene Filter Drain State fully or half-perforated as required and adjust codes as noted. Order Seals and Couplings separately if required.	400	400	460	RD400X6PEP	5	P.O.A	
	450	450	514	RD450X6PEP	1	P.O.A	
	500	500	571	RD500X6PEP	1	P.O.A	
	600	592	675	RD600X6PEP	1	P.O.A	
	750	766	883	RD750X6PEP	1	P.O.A	
	900	914	1040	RD900X6PEP	1	P.O.A	
	1050	1065	1215	RD1050X6PE P or HP*	1	2240.82	373.47

P = Perforated HP = Half-Perforated HP* = Made to Order

Integrally Socketed Polypropylene Carrier Drain

Description	Nom. Size	ID(mm)	OD(mm)	Code	Pack quantity	Price per length	Price per metre
Carrier Drain (6 metre lengths) Price includes one integral socket. Order Seals separately if required.	400	400	460	RD400X6	5	427.30	71.22
	450	450	514	RD450X6	1	459.80	76.63
	500	500	571	RD500X6	1	541.69	90.28
	600	592	675	RD600X6	1	709.20	118.20
Carrier Drain (3 metre lengths) Price includes one integral socket. Order Seals separately if required.	750	766	883	RD750X3	1	456.18	152.06
	900	914	1040	RD900X3	1	792.12	264.05

* Check availability prior to order placement. Plain ended pipe.

PLEASE ALLOW 3 DAYS FOR DELIVERY

PLEASE ALLOW 7 DAYS FOR DELIVERY

MADE TO ORDER ONLY

RIDGIDRAIN ADVANCED DRAINAGE SYSTEM

Integrally Socketed Polypropylene Filter Drain



150 to 900mm

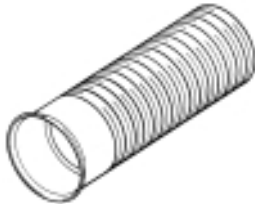

100 to 900mm

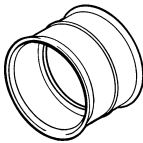

Description	Nom. Size	ID(mm)	OD(mm)	Code	Pack quantity	Price per length	Price per metre
Filter Drain (6 metre lengths)	400	400	460	RD400X6 P or HP*	5	471.53	78.59
	450	450	514	RD450X6 P or HP*	1	487.24	81.21
	500	500	571	RD500X6 P or HP*	1	574.20	95.70
	600	592	675	RD600X6 P or HP*	1	751.78	125.30

Filter Drain (3 metre lengths)	750	766	883	RD750X3 P or HP*	1	492.90	164.30
	900	914	1040	RD900X3 P or HP*	1	853.33	284.44

Price includes one integral socket. Order seals separately if required.
 State fully or half-perforated as required and adjust codes as noted.
 P = Perforated HP = Half-Perforated **HP* = Made to Order**

Double Socket Couplings

Description	Nom. Size(mm)	Code	Pack Qty	Price (each)
Double Socket Couplings One Coupling and two Seals required per joint. Seals supplied separately.	100	CRD100	43	3.48
	150	CRD150	18	5.67
	225	CRD225	7	11.71
	300	CRD300	3	21.49
	375	CRD375	1	38.76
	400	CRD400DS	1	43.24
	450	CRD450DS	1	52.05
	500	CRD500DS	1	76.26
	600	CRD600DS	1	105.80
	750	CRD750	1	239.56
	900	CRD900	1	299.12
	1050	CRD1050	1	306.00

Sealing Rings

Description	Nom. Size(mm)	Code	Pack Qty	Price (each)
Sealing Rings EPDM Seals to BS EN681: Part 1 are standard. Optional nitrile seals are available (BBA pending), subject to lead times and order quantity. Add 15% to the prices shown and state at time of enquiry or order.	100	SRD100	170	1.00
	150	SRD150	72	2.72
	225	SRD225	28	5.89
	300	SRD300	18	8.68
	375	SRD375	10	17.17
	400	SRD400	2	17.41
	450	SRD450	2	19.26
	500	SRD500	2	32.59
	600	SRD600	2	48.01
	750	SRD750	1	70.00
	900	SRD900	1	93.36
	1050	SRD1050	1	121.00

PLEASE ALLOW 3 DAYS FOR DELIVERY

PLEASE ALLOW 7 DAYS FOR DELIVERY

MADE TO ORDER ONLY

RIDGIDRAIN ADVANCED DRAINAGE SYSTEM

Double Socketed Bends

Description	Nom. Size(mm)	Code	Pack Qty	Price (each)
11.25° Bends Order seals if required. All bends double socketed except 750, 900 and 1050mm sizes which are plain ended. These bends are made to order and subject to lead times.	100	BRD100X11.25	1	25.22
	225	BRD225X11.25	1	86.63
	300	BRD300X11.25	1	150.16
	375	BRD375X11.25	1	276.82
	400	BRD400X11.25	1	318.44
	450	BRD450X11.25	1	332.85
	500	BRD500X11.25	1	459.35
	600	BRD600X11.25	1	530.63
	750	BRD750X11.25	1	1317.50
	900	BRD900X11.25	1	1525.29
1050	BRD1050X11.25	1	1838.33	
Injection Moulded 15° Bend	150	BRD150X15	10	26.94
22.5° Bends Order seals if required. All bends double socketed except 750, 900 and 1050mm sizes which are plain ended. These bends are made to order and subject to lead times.	100	BRD100X22.5	1	25.22
	225	BRD225X22.5	1	86.63
	300	BRD300X22.5	1	150.16
	375	BRD375X22.5	1	276.82
	400	BRD400X22.5	1	318.44
	450	BRD450X22.5	1	332.85
	500	BRD500X22.5	1	459.35
	600	BRD600X22.5	1	530.63
	750	BRD750X22.5	1	1317.50
	900	BRD900X22.5	1	1525.29
1050	BRD1050X22.5	1	1838.33	
Injection Moulded 30° Bend	150	BRD150X30	10	27.26
Injection Moulded 45° Bends	100	BRD100X45	25	24.12
	150	BRD150X45	10	26.94
45° Bends Order seals if required. All bends double socketed except 750, 900 and 1050mm sizes which are plain ended. These bends are made to order and subject to lead times.	225	BRD225X45	1	86.63
	300	BRD300X45	1	150.16
	375	BRD375X45	1	276.82
	400	BRD400X45	1	318.44
	450	BRD450X45	1	332.85
	500	BRD500X45	1	459.35
	600	BRD600X45	1	530.63
	750	BRD750X45	1	1317.50
	900	BRD900X45	1	1525.29
	1050	BRD1050X45	1	1838.33
Injection Moulded 87.5° Bends	100	BRD100X87.5	15	24.12
	150	BRD150X87.5	10	26.94
90° Lobster Back Bends Order seals if required. All bends double socketed except 750, 900 and 1050mm sizes which are plain ended. These bends are made to order and subject to lead times.	225	BLBRD225X90	1	173.26
	300	BLBRD300X90	1	287.43
	375	BLBRD375X90	1	553.61
	400	BLBRD400X90	1	553.61
	450	BLBRD450X90	1	665.71
	500	BLBRD500X90	1	918.70
	600	BLBRD600X90	1	1061.25
	750	BLBRD750X90	1	2896.63
	900	BLBRD900X90	1	3364.62
	1050	BLBRD1050X90	1	4541.11

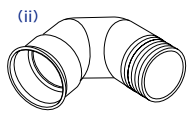
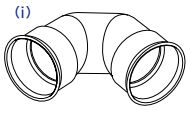
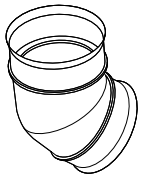
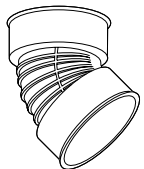
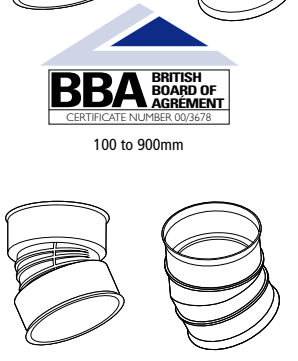
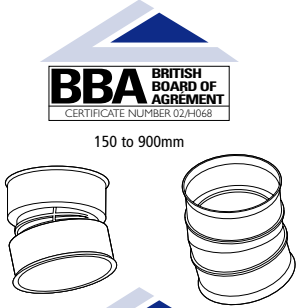

PLEASE ALLOW 3 DAYS FOR DELIVERY

PLEASE ALLOW 7 DAYS FOR DELIVERY

MADE TO ORDER ONLY

RIDGIDRAIN ADVANCED DRAINAGE SYSTEM

Junctions

Description	A(mm)	B(mm)	Code	Pack Qty	Price (each)
-------------	-------	-------	------	----------	--------------

90° Bends

Order seals if required.

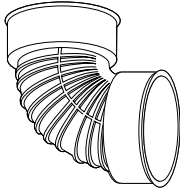

Injection Moulded 45° Junctions

Order Seals if required.

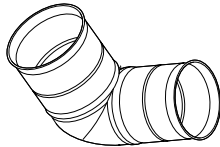

45° Junctions

Order Seals if required.

Key

A = Main bore

B = Branch

All junctions are triple socketed except 750, 900 and 1050mm.

Equal junctions in 750, 900 and 1050mm sizes are plain ended.

Unequal junctions in 750, 900 and 1050mm sizes are manufactured with a socket on the branch.

These junctions are made to order and subject to lead times.

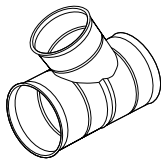
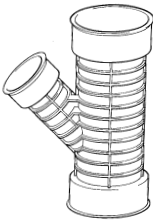

225	-	BRD225X90	1	86.63
300	-	BRD300X90	1	150.16
375	-	BRD375X90	1	276.82
400	-	BRD400X90	1	318.44
450	-	BRD450X90	1	332.85
500	-	BRD500X90	1	459.35
600	-	BRD600X90	1	530.63
750	-	BRD750X90	1	1448.30
900	-	BRD900X90	1	1682.33
1050	-	BRD1050X90	1	2270.56
100	100	JRD100100Y	10	35.47
150	100	JRD150100Y	5	47.49
150	150	JRD150150Y	5	47.49
225	150	JRD225150Y	1	109.29
300	150	JRD300150Y	1	142.10
225	100	JRD225100Y	1	103.81
225	225	JRD225225Y	1	175.52
300	100	JRD300100Y	1	137.14
300	225	JRD300225Y	1	315.38
300	300	JRD300300Y	1	556.23
375	100	JRD375100Y	1	239.59
375	150	JRD375150Y	1	235.03
375	225	JRD375225Y	1	332.96
375	300	JRD375300Y	1	516.73
375	375	JRD375375Y	1	650.86
400	150	JRD400150Y	1	247.98
400	400	JRD400400Y	1	653.07
450	100	JRD450100Y	1	253.32
450	150	JRD450150Y	1	264.39
450	225	JRD450225Y	1	421.08
450	300	JRD450300Y	1	457.09
450	450	JRD450450Y	1	844.64
500	150	JRD500150Y	1	354.69
500	225	JRD500225Y	1	472.01
500	300	JRD500300Y	1	516.73
500	500	JRD500500Y	1	1182.53
600	100	JRD600100Y	1	397.49
600	150	JRD600150Y	1	380.81
600	225	JRD600225Y	1	491.87
600	300	JRD600300Y	1	1286.83
600	600	JRD600600Y	1	1286.83
750	150	JRD750150Y	1	989.16
750	750	JRD750750Y	1	3229.83
900	150	JRD900150Y	1	1044.41
900	900	JRD900900Y	1	3487.79
1050	150	JRD1050150Y	1	1307.72
1050	1050	JRD10501050Y	1	4715.05

**Other specialist junctions
maybe available on request.**

PLEASE ALLOW 3 DAYS FOR DELIVERY

PLEASE ALLOW 7 DAYS FOR DELIVERY

MADE TO ORDER ONLY

RIDGIDRAIN ADVANCED DRAINAGE SYSTEM

Junctions

Description	A(mm)	B(mm)	Code	Pack Qty	Price (each)
Injection Moulded 90° Junctions					
Order Seals if required.	100	100	JRD100100T	10	35.47
	150	100	JRD150100T	10	47.49
	150	150	JRD150150T	1	47.49
90° Junctions					
Order Seals if required.	225	100	JRD225100T	1	103.81
	225	150	JRD225150T	1	123.00
	225	225	JRD225225T	1	175.52
	300	100	JRD300100T	1	137.14
	300	150	JRD300150T	1	153.18
	300	225	JRD300225T	1	315.38
	300	300	JRD300300T	1	532.42
	375	100	JRD375100T	1	223.59
	375	150	JRD375150T	1	235.03
	375	225	JRD375225T	1	322.96
	375	300	JRD375300T	1	516.73
	375	375	JRD375375T	1	650.86
	400	150	JRD400150T	1	247.98
	400	400	JRD400400T	1	653.07
	450	100	JRD450100T	1	263.32
	450	150	JRD450150T	1	265.97
	450	225	JRD450225T	1	421.08
	450	300	JRD450300T	1	457.09
	450	450	JRD450450T	1	844.64
	500	100	JRD500100T	1	337.86
	500	150	JRD500150T	1	354.69
	500	225	JRD500225T	1	472.01
	500	300	JRD500300T	1	516.73
	500	500	JRD500500T	1	1182.50
	600	100	JRD600100T	1	397.49
	600	150	JRD600150T	1	380.81
	600	225	JRD600225T	1	491.87
	600	300	JRD600300T	1	1286.83
	600	600	JRD600600T	1	1286.83
	750	150	JRD750150T	1	955.83
	750	750	JRD750750T	1	2981.05
	900	150	JRD900150T	1	1010.79
	900	900	JRD900900T	1	3243.91
	1050	150	JRD1050150T	1	1274.43
	1050	1050	JRD10501050T	1	4292.74

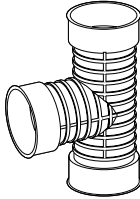

Key
A = Main bore
B = Branch

All junctions are triple socketed except 750, 900 and 1050mm.

Equal junctions in 750, 900 and 1050mm sizes are plain ended.

Unequal junctions in 750, 900 and 1050mm sizes are manufactured with a socket on the branch. These junctions are made to order and subject to lead times.

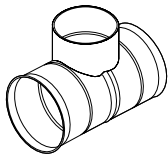

Other specialist junctions maybe available on request.

GULLIES & ACCESSORIES

End Caps

Description	Size (mm)	Code	Pack Qty	Price (each)
End Cap (No seals or couplings supplied)	100	EC1059	10	2.43
	150	EC1778	10	5.85
	225	EC5064	10	22.97
	300	EC6010	10	40.68

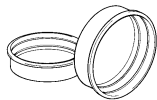

Not suitable for air tests.

PLEASE ALLOW 3 DAYS FOR DELIVERY

PLEASE ALLOW 7 DAYS FOR DELIVERY

MADE TO ORDER ONLY

GULLIES & ACCESSORIES

Midi-Gully HDPE Yard Gully & Accessories

Description	Code	Pack Qty	Price (each)
300mm Diameter x 600mm Depth HDPE Yard Gully	RG300600	36	42.88
Silt Bucket	RGSB	1	54.77
Grating (Class B125 to BS EN124)	RGG	1	154.57



Ridgigully HDPE Road Gullies & Adaptors

Description	Code	Pack Qty	Price (each)
450mm Diameter x 750mm Depth HDPE Road Gully	RG450750	16	46.44
450mm Diameter x 900mm Depth HDPE Road Gully	RG450900	16	48.24
Multi-Adaptor	ARGMulti	20	9.80

Ridgiflex 150mm Diameter HDPE Gully Connection Pipe

Description	OD (mm)	Code	Price (each)
25 metre coil	178	RF150X25	149.21

ADAPTORS

Level Invert Reducers

Description	A(mm)	B(mm)	Code	Price (each)
Level Invert Reducers Other Level Invert Reducers are available on request.	150	100	ARD150100	27.90
	225	150	ARD225150	40.87
	300	150	ARD300150	65.88
	300	225	ARD300225	77.28
	375	225	ARD375225	117.44
	375	300	ARD375300	153.65
	500	450	ARD500450	P.O.A
	600	500	ARD600500	P.O.A

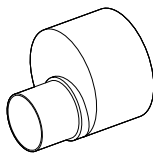

Polypipe Ridgidrain to BS4660 Spigot

Description	Code	Pack Qty	Price (each)
100mm socket to 110mm EN1401 (BS4660) spigot	ARD100110	10	19.30
150mm socket to 160mm EN1401 (BS4660) spigot	ARD150160	10	26.31

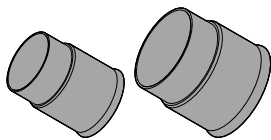

Polypipe Ridgidrain to BS4660 Socket

Description	Code	Pack Qty	Price (each)
100mm socket to 110mm EN1401 (BS4660) socket	ARD100110 & UG401	10	19.30+4.84
150mm socket to 160mm EN1401 (BS4660) socket	ARD150160 & UG601	10	26.31+9.54

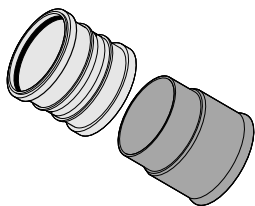

PLEASE ALLOW 3 DAYS FOR DELIVERY PLEASE ALLOW 7 DAYS FOR DELIVERY MADE TO ORDER ONLY

ADAPTORS

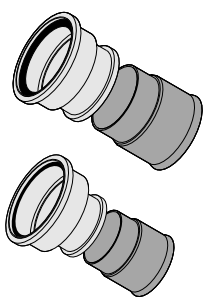

Polypipe Ridgidrain to Super Clay Socket

Description	Code	Pack Qty	Price (each)
100mm socket to 100mm super clay socket	ARD100110 & UG434	10	19.30+9.02
150mm socket to 150mm super clay socket	ARD150160 & UG634	10	26.31+13.57

Polypipe Ridgidrain to Thick Clay Socket

Description	Code	Pack Qty	Price (each)
100mm socket to 100mm thick clay socket	ARD100110 and UG486	10	19.30+9.59
150mm socket to 150mm thick clay socket	ARD150160 and UG696	10	26.31+14.24

Order seals separately if required

SPECIALIST FABRICATIONS

Following the outstanding track record of conventional Ridgidrain pipe and fittings, Polypipe Civils have made a substantial capital investment in a state of the art fabrications facility.

Fabrications are manufactured in sizes up to 2 metres in diameter and include:

- Catchpits
- Manholes
- Soakaways
- Ducting drawpits
- Pump sampling and inspection chambers

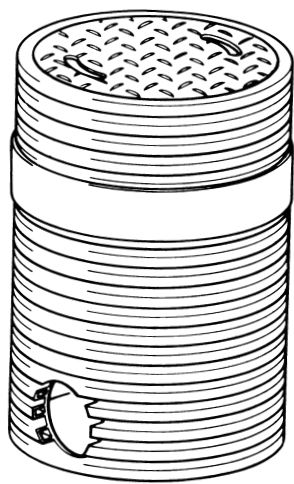

Fabrications can be made to precise customer specifications with standard products also available for road and rail applications.



Benefits:

- Fabricated to exact customer specifications
- Excellent impact and abrasion resistance properties
- Minimal storage space required
- Lightweight
- Versatility and adaptability
- Single piece or segmented constructions available
- Optional Step Irons to BS1247

All the fittings are fully compatible with Polypipe Civils Ridgidrain system.

POLYSTORM SYSTEM

Polystorm System

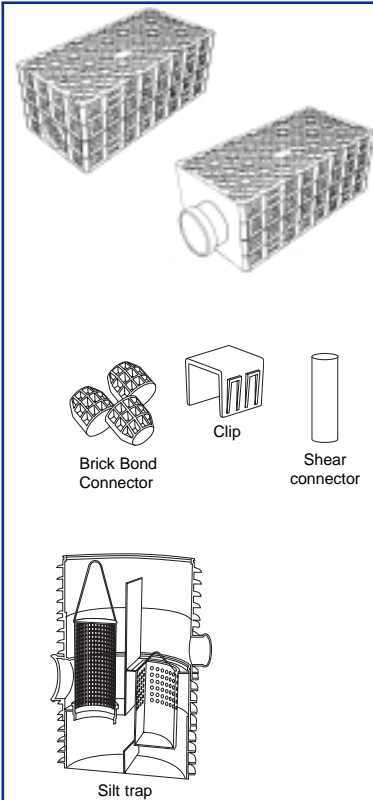

Description	Code	Pack Qty	Price (each)
Polystorm Cell 1000x500x400mm	PSM1	15	66.36
Polystorm Cell with 225mm connector	PSMCRD225	1	123.10
Polystorm Cell with 300mm connector	PSMCRD300	1	123.10
Polystorm Lite Cell	PSM2	15	41.56
Polystorm Lite flow control unit for Cover and Frame order UG512 square or UG511 round	PSMFC160/30	1	523.74
Brick bond shear connector	PSMBBSC	30	0.95
Clips	PSMCLIP	60	0.95
Shear connector	PSMSC	30	0.95
EN1401 Flange Adaptor - 110mm	PSMFA110	1	29.14
Ridgidrain Flange Adaptor - 150mm	PSMFA150	1	29.14
EN1401 Flange Adaptor - 160mm	PSMFA160	1	29.14
Basic silt trap	PSMST160	1	323.75
Advanced silt trap - 15 litres / sec	PSMSTA160/15	1	566.58
Mini Silt Trap for Polystorm Lite	PSMST110	1	96.69
Cover & Frame (Round)	UG501	1	34.68
Cover & Frame (Square)	UG502	1	37.07
450mm silt trap lid & frame	UG512	1	65.54
460mm lockable plastic cover & frame	UG511	1	45.93
Polypropylene cover & frame	ICDC1	1	65.54
Chamber riser section	ICDR1	1	28.69
Silt trap sealing ring	UG488	1	2.61

PLEASE ALLOW 3 DAYS FOR DELIVERY

PLEASE ALLOW 7 DAYS FOR DELIVERY

MADE TO ORDER ONLY

STORMCHECK CHAMBER

The Stormcheck "Vortex Flow Control Chamber" is the latest addition to the Sustainable Drainage (SUDS) suite of products from Polypipe Civils.

The new Stormcheck chamber allows precise control of site discharge rates.

Features:

- Pre-fabricated to customer specification.
- Choice of Depth up to a maximum invert level of six meters.
- Lightweight, yet tough and durable product.
- Designed to be used in conjunction with Polypipe Stormwater Solutions.
- Choice of chamber sizes from: 1050mmØ, 1200mmØ, 1500mmØ and 1800mmØ.
- Option of Step Irons to BS1247

Polypipe Civils manufactures a range of chambers, available with or without bypass systems.

Benefits of the Stormcheck Chamber

- Produced in our dedicated fabrications department.
- Built to exacting customer specifications and delivered to site ready to be installed.
- The factory fitted Vortex Control Device saves the contractor time.
- Vortex Control Devices are widely recognised as being the most hydraulically efficient means of flow regulation.
- Integral sump for silt catchment
- Optional drain down system to ease maintenance and silt removal.
- The Stormcheck Chamber can be integrated with any Polypipe SUDS Solution and the market leading Ridgidrain ADS System.



RIDGIDRAIN FIN AND NARROW FILTER DRAINS

Type 6 Fin Drain

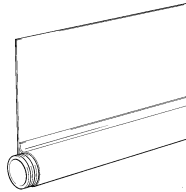

Description	Depth (mm)	Code	Price
Type 6 Fin Drain	600	FD80X12.5X600	8.84
	750	FD80X12.5X750	10.98
	600	FD100X12.5X600	10.84
	750	FD100X12.5X750	11.90
	600	FD160X12.5X600	12.54
	750	FD160X12.5X750	14.67

Single wall corrugated pipe to BS 4962:1989 supplied assembled with plastic fin wrapped in geotextile. Available in 80, 100 and 160mm diameters. Insert required diameter in place of 'S' in product code.

These items are made to order and subject to lead times. Minimum order 10 packs per size

Type 8 Filter Drain

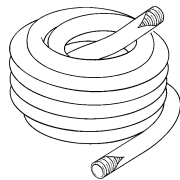

Description	Diameter (mm)	Length (m)	Code	Price (each)
Type 8 Filter Drain	60	150	GE60150	248.61
	80*	100	GE80100	239.77
	100*	100	GE100100	334.99
	125	75	GE12575	354.38
	160	45	GE16045	324.43

Pipe supplied wrapped in geotextile. These items are made to order and subject to lead times and minimum order quantities.

* These items are available from stock.



LUBRICANT

Lubricant

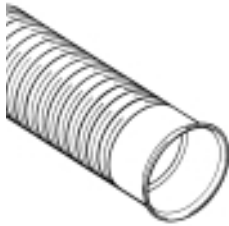

Description	Size	Code	Pack Qty	Price (each)
Plastic Tub of Lubricant	1kg	LUBX1	12	9.16
	2.5kg	LUBX2.5	4	22.83
Minimum Usage Chart	Diameter (mm)	kg per pallet	Diameter (mm)	Joints per kg
	100	0.5	400	64
	150	0.4	450	56
	225	0.3	500	48
	300	0.2	600	40
	375	0.15	750	25
			900	20
			1050	15

RIDGISEWER

WIS 4-35-01
KM55701
Covers pipe, seals and couplings

Pipe							
Description	Nom. Size	ID(mm)	OD(mm)	Code	Pack quantity	Price per length	Price per metre
Integrally Socketed Stiffness Class 4 6 metre lengths	400	400	457	RSW400X6IS4	5	444.97	74.16
	450	450	511	RSW450X6IS4	1	478.83	79.81
	500	500	568	RSW500X6IS4	1	564.07	94.01
	600	587	672	RSW600X6IS4	1	738.52	123.09
3 metre lengths	400	400	457	RSW400X3IS4	5	222.48	74.16
	450	450	511	RSW450X3IS4	1	239.42	79.81
	500	500	568	RSW500X3IS4	1	282.04	94.01
	600	587	672	RSW600X3IS4	1	369.24	123.08
	750	765	880	RSW750X3IS4	1	510.93	170.31
	900	909	1032	RSW900X3IS4	1	855.55	285.18

Order seals and couplings separately as required.

Stiffness Class 8 and Plain ended Ridgisewer is available as a special made to order item and is subject to minimum order quantities and lead times.

RIDGISEWER

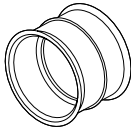
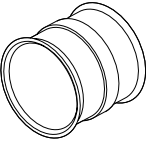



Double Socket Couplings					
Description	Nom. Size (mm)	Code	Pack Qty	Price (each)	
Double Socket Couplings Order seals separately if required.	400	RSWC400	1	45.53	
	450	RSWC450	1	51.77	
	500	RSWC500	1	80.30	
	600	RSWC600	1	111.44	



WIS 4-35-01
KM55701

Double Socket Slip Couplings					
Description	Nom. Size (mm)	Code	Pack Qty	Price (each)	
Double Socket Slip Couplings Order seals separately if required.	400	RSWSC400	1	47.80	
	450	RSWSC450	1	54.33	
	500	RSWSC500	1	84.32	
	600	RSWSC600	1	116.47	



RIDGISEWER

Sealing Rings

Description	Nom. Size (mm)	Code	Pack Qty	Price (each)
-------------	----------------	------	----------	--------------



Sealing Rings

Ridgidrain and Ridgisewer seals are now identical and offered at the same list price.



WIS 4-35-01
KM55701

400	SRD400	2	17.41
450	SRD450	2	19.26
500	SRD500	2	32.59
600	SRD600	2	48.01
750	SRD750	1	70.00
900	SRD900	1	93.36

End Caps

Description	Nom. Size (mm)	Code	Pack Qty	Price (each)
-------------	----------------	------	----------	--------------

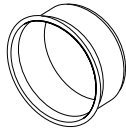

End Caps

Order seals separately if required.



400	RSWEC400	1	45.53
450	RSWEC450	1	51.77
500	RSWEC500	1	80.30
600	RSWEC600	1	111.44
750	RSWEC750	1	252.38
900	RSWEC900	1	315.03

Bends

Description	Nom. Size (mm)	Code	Pack Qty	Price (each)
-------------	----------------	------	----------	--------------

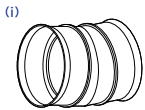

(ii)

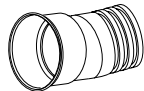

11.25° Short Radius Bends

Order seals separately if required.

These bends are made to order and subject to lead times.

i	400	RSWB40011.25	1	320.78
	450	RSWB45011.25	1	335.31
	500	RSWB50011.25	1	462.74
	600	RSWB60011.25	1	534.53
ii	750	RSWB75011.25	1	1327.25
	900	RSWB90011.25	1	1536.56

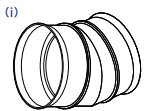

(ii)

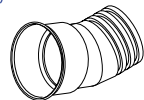

22.5° Short Radius Bends

Order seals separately if required.

These bends are made to order and subject to lead times.

i	400	RSWB40022.5	1	320.78
	450	RSWB45022.5	1	335.31
	500	RSWB50022.5	1	462.74
	600	RSWB60022.5	1	534.53
ii	750	RSWB75022.5	1	1327.25
	900	RSWB90022.5	1	1536.56

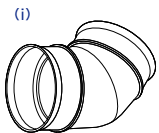

(ii)

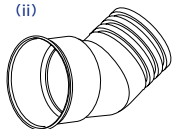

45° Short Radius Bends

Order seals separately if required.

These bends are made to order and subject to lead times.

i	400	RSWB40045	1	320.78
	450	RSWB45045	1	335.31
	500	RSWB50045	1	462.74
	600	RSWB60045	1	534.53
ii	750	RSWB75045	1	1327.25
	900	RSWB90045	1	1536.56

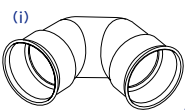

(ii)

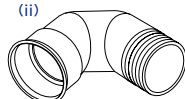

90° Short Radius Bends

Order seals separately if required.

These bends are made to order and subject to lead times.

i	400	RSWB40090	1	320.78
	450	RSWB45090	1	335.31
	500	RSWB50090	1	462.74
	600	RSWB60090	1	534.53
ii	750	RSWB75090	1	1459.01
	900	RSWB90090	1	1694.75

PLEASE ALLOW 3 DAYS FOR DELIVERY

PLEASE ALLOW 7 DAYS FOR DELIVERY

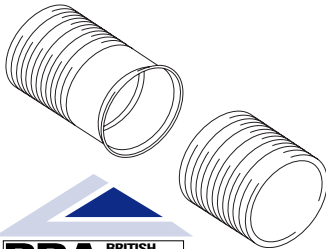
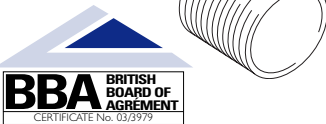

MADE TO ORDER ONLY

RIDGISEWER

Bends				
Description	Nom. Size (mm)	Code	Pack Qty	Price (each)
 Rocker pipes Order seals separately if required.	750	RSWRP750	1	P.O.A.
	900	RSWRP900	1	P.O.A.
 Stub pipes Order seals separately if required.	750	RSWST750	1	P.O.A.
	900	RSWST900	1	P.O.A.

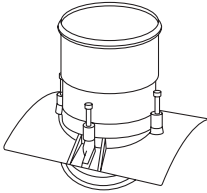

RIDGITITE

Ridgitite				
Description	Description	Code	Pack Qty	Price (each)
 Connecting Saddles to suit Ridgidrain & Ridgisewer except as noted  PT/193/1102	300mm	SLD300	1	142.70
	375/400/450mm	SLD375450	1	149.12
	500mm	SLD500	1	175.72
	600mm	SLD600	1	188.88
	300mm Polysewer	SLDPS300	1	142.70
	177mm Hole Saw	HOL177	1	P.O.A.

RIDGISEWER

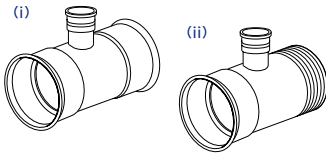
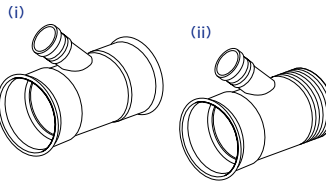
Junctions				
Description	Nom. Size (mm)	Code	Pack Qty	Price (each)
 90° Unequal Junctions Order seals separately if required. ii. These junctions are made to order and subject to lead times.	400x160	RSWJ400160T	1	249.80
	450x160	RSWJ450160T	1	267.94
	500x160	RSWJ500160T	1	357.30
	600x160	RSWJ600160T	1	383.64
	750x160	RSWJ750160T	1	962.88
	900x160	RSWJ900160T	1	1052.10
 110 & 160mm branches are for EN1401 pipes. 150mm branches are for Polysewer.	400x150	RSWPSJ400150T	1	249.80
	450x150	RSWPSJ450150T	1	267.94
	500x150	RSWPSJ500150T	1	357.30
	600x150	RSWPSJ600150T	1	383.64
	750x150	RSWPSJ750150T	1	962.88
	900x150	RSWPSJ900150T	1	1018.57



PLEASE ALLOW 3 DAYS FOR DELIVERY PLEASE ALLOW 7 DAYS FOR DELIVERY MADE TO ORDER ONLY

RIDGISEWER

Junctions

Description	Nom. Size (mm)	Code	Pack Qty	Price (each)
-------------	----------------	------	----------	--------------

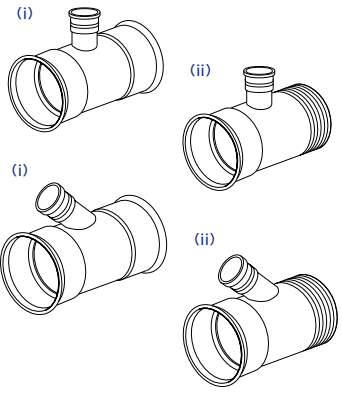

45° Unequal Junctions
 Order seals separately if required.
 110 & 160mm branches are for EN1401 pipes.
 150mm branches are for Polysewer.

ii. These junctions are made to order and subject to lead times.

i	400x110	RSWJ400110Y	1	241.85
	400x160	RSWJ400160Y	1	249.80
	450x110	RSWJ450110Y	1	265.26
	450x160	RSWJ450160Y	1	267.94
ii	500x160	RSWJ500160Y	1	357.30
	600x160	RSWJ600160Y	1	383.64
	750x160	RSWJ750160Y	1	996.46
	900x160	RSWJ900160Y	1	1052.10
i	400x150	RSWPSJ400150Y	1	249.80
	450x150	RSWPSJ450150Y	1	267.94
	500x150	RSWPSJ500150Y	1	357.30
	600x150	RSWPSJ600150Y	1	383.64
ii	750x150	RSWPSJ750150Y	1	996.46
	900x150	RSWPSJ900150Y	1	1052.10

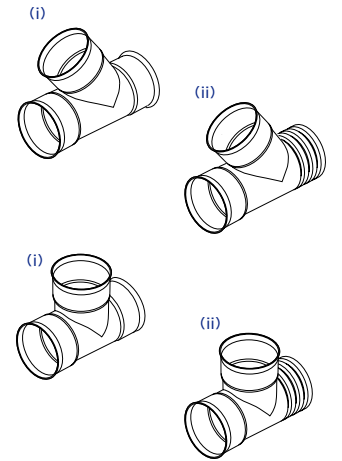

45° Equal Junctions
 Order seals separately if required.

(ii) These junctions are made to order and subject to lead times.

i	400	RSWEJ400Y	1	657.88
	450	RSWEJ450Y	1	850.85
	500	RSWEJ500Y	1	1191.22
	600	RSWEJ600Y	1	1296.32
ii	750	RSWEJ750Y	1	3253.67
	900	RSWEJ900Y	1	3513.54

90° Equal Junctions
 Order seals separately if required.

(ii) These junctions are made to order and subject to lead times.

i	400	RSWEJ400T	1	657.88
	450	RSWEJ450T	1	850.85
	500	RSWEJ500T	1	1191.22
	600	RSWEJ600T	1	1296.32
ii	750	RSWEJ750T	1	3003.06
	900	RSWEJ900T	1	3267.85



3m 45° Junctions

Description	Nom. Size (mm)	Branch Size (mm)	Code	Pack Qty	Price
-------------	----------------	------------------	------	----------	-------

Single Branch These are specialist fabrications, manufactured to order and subject to extended lead times Double branch junctions available Made to Order	400	150	RSWPSJ400150YX3S	1	P.O.A.
	400	160	RSWJ400160YX3S	1	P.O.A.
	450	150	RSWPSJ450150YX3S	1	P.O.A.
	450	160	RSWJ450160YX3S	1	P.O.A.
	500	150	RSWPSJ500150YX3S	1	P.O.A.
	500	160	RSWJ500160YX3S	1	P.O.A.
	600	150	RSWPSJ600150YX3S	1	P.O.A.
	600	160	RSWJ600160YX3S	1	P.O.A.
	750	150	RSWPSJ750150YX3S	1	P.O.A.
	750	160	RSWJ750160YX3S	1	P.O.A.
	900	150	RSWPSJ900150YX3S	1	P.O.A.
	900	160	RSWJ900160YX3S	1	P.O.A.

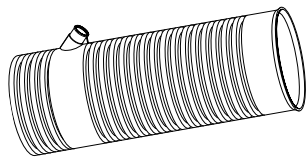

POLYSEWER

Integrally Socketed Pipe Class 8

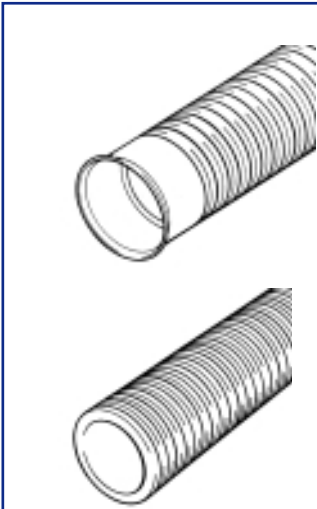

Description	Nom. Size	ID(mm)	OD(mm)	Code	Length	Pack Qty	Price per length	Price per metre
Integrally Socketed pipe	150	146	160	PS632	3	46	19.83	6.61
	225	229	160	PS1032	3	23	46.65	15.55
	300	301	330	PS1232	3	9	71.31	23.77
	150	146	160	PS662	6	46	39.65	6.61
	225	229	250	PS1062	6	23	91.73	15.29
	300	301	330	PS1262	6	9	141.08	23.51
Plain Ended pipe	150	146	160	PS630	3	46	17.27	5.76
	225	229	250	PS1030	3	23	43.12	14.37
	300	301	330	PS1230	3	9	62.54	20.85
	150	146	160	PS660	6	46	34.55	5.76
	225	229	250	PS1060	6	23	86.27	14.38
	300	301	330	PS1260	6	9	129.94	21.66

Double Socket Coupling

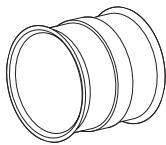

Description	Nom. Size (mm)	Code	Pack Qty	Price (each)
Double Socket coupling (Supplied with 2 seals)	150	PS601	10	7.86
	225	PS1001	1	19.18
	300	PS1201	1	37.26

Bends

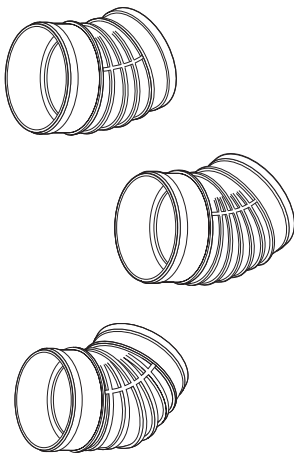

Description	Nom. Size (mm)	Code	Pack Qty	Price (each)
15 degree bends (supplied with 2 seals)	150	PS609	10	13.50
	225	PS1009	1	51.62
	300	PS1209	1	84.21
30 degree bends (supplied with 2 seals)	150	PS667	10	13.50
	225	PS1067	1	53.16
	300	PS1267	1	88.60
45 degree bends (supplied with 2 seals)	150	PS603	10	13.50
	225	PS1003	1	54.51
	300	PS1203	1	91.27
90 degree bends (supplied with 2 seals)	150	PS611	5	15.79
	225	PS1011	1	67.21
	300	PS1211	1	106.40

PLEASE ALLOW 3 DAYS FOR DELIVERY

PLEASE ALLOW 7 DAYS FOR DELIVERY

MADE TO ORDER ONLY

POLYSEWER

End Caps

Description	Nom. Size (mm)	Code	Pack Qty	Price (each)
End Caps (each supplied with 1 seal)	150	PS6101	10	5.76
	225	PS10101	1	19.86
	300	PS12101	1	29.81

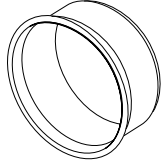

Junctions

Description	Nom. Size (mm)	Code	Pack Qty	Price (each)
45° Equal junctions	150	PS605	5	27.47
	225	PS1005	1	99.94
	300	PS1205	1	213.85
90° Equal junctions	150	PS623	5	27.47
45° Unequal Junctions	150x110	PS635RS	5	24.13
	225x110	PS1035RS	1	77.80
	225x150	PS1031	1	65.06
	225x160	PS1031RS	1	70.34
	300x110	PS1235RS	1	123.48
	300x150	PS1231	1	105.82
	300x160	PS1231RS	1	111.12
	300x225	PS12100	1	203.56
90° Unequal junctions	150x110	PS643RS	5	24.13

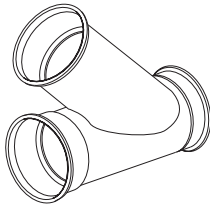

Other Adaptors ie: for clay pipes are available on request

Socket Adaptors

Description	Nom. Size (mm)	Code	Pack Qty	Price (each)
Socket Adaptors to EN1401-1 (Each supplied with 2 seals)	150	PS689	10	24.40
	225	PS1089	1	67.18
	300	PS1289	1	83.24

Level Invert Reducers

Description	A(mm)	B(mm)	Code	Pack Qty	Price (each)
Level Invert Reducers (Supplied with seals)	225	150	PS1021	1	45.04
	300	220	PS1221	1	82.22

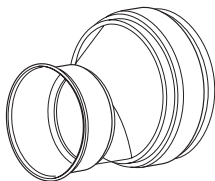

Sealing Rings and Rodding Eye

Description	Nom. Size (mm)	Code	Pack Qty	Price (each)
Sealing Rings	150	PSSP1	10	0.93
	225	PSSP2	10	1.90
	300	PSSP3	10	4.13
Rodding Eye	150	PS6225	8	61.36

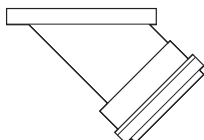

PLEASE ALLOW 3 DAYS FOR DELIVERY

PLEASE ALLOW 7 DAYS FOR DELIVERY

MADE TO ORDER ONLY

DUCTING SYSTEMS

Typical Colour Coding and Important Notes

Description

- | | |
|--|---------------------------------------|
| Black (B) - Electricity | Yellow (Y) - Gas |
| Orange (O) - Street Lighting | Blue (BL) - Water |
| Purple (P) - Motorway Communications | Green (G) - Cable Television |
| Purple (P) - Street Lighting (Scotland) | Grey (GR) - Telecommunications |

Colours and printing may vary from region to region, please check with appropriate authority.

Special colours and prints may be subject to lead times and minimum order quantities. Slow moving products may also be subject to minimum order quantities and lead times. Availability must be checked with Polypipe Civils prior to order placement.

If a specific grade of colour is required this should be stated at time of enquiry and order placement. Supply may be subject to lead times and minimum order quantities. The colour of standard black uPVC ducting products ranges from grey to black.

RIDGIDUCT - TWIN WALL DUCT

Ridgiduct - Black Twin Wall Electric Cable Duct

Description	ID (mm)	OD (mm)	Code	Pack Qty	Price per length	Price per metre
2 metre lengths	100	118	RB100X2	85	10.15	5.08
Printed Electric Cable Duct	125	148	RB125X2	46	14.28	7.14
	150	178	RB150X2	36	14.93	7.47
	3 metre lengths	100	118	RB100X3	85	14.21
Printed Electric Cable Duct	125	148	RB125X3	46	20.38	6.79
	150	178	RB150X3	36	21.38	7.13
	6 metre lengths	94	110	RB94X6	95	16.90
Printed Electric Cable Duct	100	118	RB100X6	85	23.88	3.98
	125	148	RB125X6	46	33.44	5.57
	150	178	RB150X6	36	34.97	5.83

A range of coloured ducts are available made to order, subject to minimum order quantities and lead times.

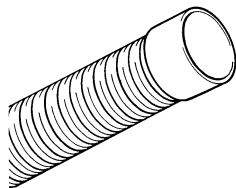

High Density Polyethylene twin wall ducting (Not including 94mm ducts) for underground cables, is manufactured to ESI 12/24 and BS EN50086-2-4.

Supplied with one coupling fitted per length.

PLEASE ALLOW 3 DAYS FOR DELIVERY

PLEASE ALLOW 7 DAYS FOR DELIVERY

MADE TO ORDER ONLY

RIDGIDUCT - TWIN WALL DUCT

Ridgiduct - Twin Wall Electric Cable Duct

Description	Diameter (mm)	Code	Pack Qty	Price per length	Price per metre
Ridgiduct Black Twin Wall Split Duct					
1 metre lengths	100	RB100X1S	85	7.70	7.70
	125	RB125X1S	46	10.59	10.59
	150	RB150X1S	36	13.60	13.60
2 metre lengths	100	RB100X2S	85	14.16	7.08
	125	RB125X2S	46	20.81	10.41
	150	RB150X2S	36	26.81	13.41
3 metre lengths	100	RB100X3S	85	20.29	6.76
	125	RB125X3S	46	29.86	9.95
	150	RB150X3S	36	39.40	13.13

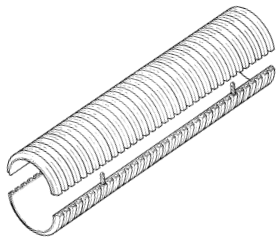

Registered Design

Ridgiduct - Motorway Communications Sealed Duct

Description	Nom. Size	Length (m)	Code	Pack Quantity	Price per length	Price per metre
Purple sealed duct	94	6	RB94X6PMCPPE	95	26.33	4.39
Printed Motorway Comms / Power	94*	12	RB94X12PMCPPE	60	52.67	4.39
	100	6	RB100X6PMCPPE	85	27.30	4.55
	100*	12	RB100X12PMCPPE	60	54.64	4.55
Black sealed duct	94*	6	RB94X6BMCPE	95	22.59	3.77
Printed Motorway Comms / Power	94*	12	RB94X12BMCPE	60	45.23	3.77
	100*	6	RB100X6BMCPE	85	24.73	4.12
	100*	12	RB100X12BMCPE	60	49.48	4.12



Order seals and couplings separately

				Price
Black Coupling	CRD94	50		3.01
	CRD100	43		3.48
Sealing Rings, EPDM to BS EN681: Part 1	SRD94	190		1.00
	SRD100	170		0.98

Nitrile seals are available subject to lead time and order quantity. Add 15% and state at time of order.

Conforms to Highways Agency Specifications for Sealed Systems.

* Made to order and are subject to minimum order quantities and lead times.

Ridgiduct - Motorway Communications Unsealed Duct

Description	Nom. Size	Length (m)	Code	Pack Quantity	Price per length	Price per metre
Purple unsealed duct	94	6	RB94X6PMCP	95	26.33	4.39
Printed Motorway Comms / Power	100	6	RB100X6PMCP	85	27.30	4.55



Supplied with 1 coupling fitted per length



Motorway Communications print option is also available made to order, subject to minimum order quantities and lead times.

RIDGIDUCT - TWIN WALL DUCT

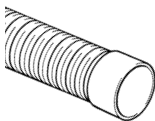
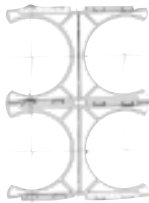
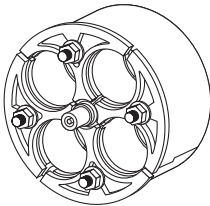

Supplied with 1 coupling fitted per length

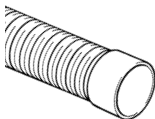

94mm Supplied with 1 coupling fitted per length
225 & 300mm supplied plain ended.
Order couplings and seals separately if required.

Comtite Duct Transit Systems

Description	Description	Code	Pack Qty	Price (each)
Plugs	94mm Duct Plug	DP94	40	38.89
	100mm Duct Plug	DP100	40	38.89
Grommets**	Blanking Insert	DPG0	10	7.01
	9mm Grommet	DPG9	10	7.01
	12mm Grommet	DPG12	10	7.01
	14mm Grommet	DPG14	10	7.01
	16mm Grommet	DPG16	10	7.01
	18mm Grommet	DPG18	10	7.01
	21mm Grommet	DPG21	10	7.01
	24mm Grommet	DPG24	10	7.01
	27mm Grommet	DPG27	10	7.01
	9mm Grommet with 4 holes	DPG9X4	10	7.01
9mm Grommet with 7 holes	DPG9X7	10	7.01	

* Required to attach draw cord if all 4 bores are occupied by cables. ** Order grommets in multiples of 10

Duct Spacers

Description	Duct (ID)	Code	Pack Qty	Price (each)
2 way Duct Spacer	94	RBS110X2	50	2.11
4 way	94	RBS110X4	25	4.23
6 way	94	RBS110X6	12	6.33
2 way Duct Spacer	100	RBS118X2	50	2.11
4 way	100	RBS118X4	25	4.23
6 way	100	RBS118X6	12	6.33

Ridgiduct - Orange Lighting

Description	ID (mm)	OD (mm)	Length (m)	Code	Pack Quantity	Price per length	Price per metre
Printed Traffic Signal (TS) or Street Lighting (SL)	94	110	6	RB94X60(TS or SL)	95	26.33	4.39
	100	118	6	RB100X60(TS or SL)	85	27.52	4.59
	150	178	6	RB150X60(TS or SL)	36	40.29	6.72

Plain ended ducts & other print options are available made to order, subject to minimum order quantities and lead times.

Ridgiduct - Utilities Ducting

Description	Nom. Size	Length (m)	Code	Pack Quantity	Price per length	Price per metre
Water Pipes (Blue)	94	6	RB94X6BL	95	26.38	4.40
	150	6	RB150X6BL	36	40.29	6.72
	225	6	RB225X6BLPE	14	104.78	17.46
	300	6	RB300X6BLPE	9	164.04	27.34
Gas Pipes (Yellow)	94	6	RB94X6Y	95	26.33	4.39
	150	6	RB150X6Y	36	40.29	6.72
	225	6	RB225X6YPE	14	104.38	17.40
	300	6	RB300X6YPE	9	164.04	27.34
Telecommunications (Green)	94	6	RB94X6G	95	26.33	4.39
	150	6	RB150X6G	36	40.29	6.72

PLEASE ALLOW 3 DAYS FOR DELIVERY

PLEASE ALLOW 7 DAYS FOR DELIVERY

MADE TO ORDER ONLY

RIDGIDUCT - TWIN WALL DUCT

Scottish Street Lighting Purple Duct and Fittings

Description	Nom. Size (mm)	ID (mm)	Code	Price (each)	Price per m
Single Wall Corrugated					
100m coil	60	53	SSL60X100P	187.89	1.88
40m coil	100	90	SSL100X40P	122.98	3.07

Supplied with 1 coupling fitted per length

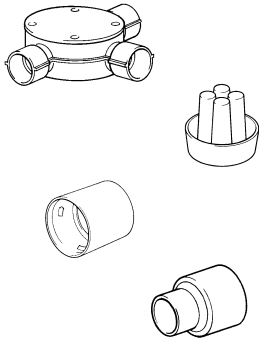

Description	Nom. Size (mm)	Code	Pack Qty	Price (each)
Junction Boxes	100	SSLJB100	10	15.24
Shrouded End Caps				
4-way	100	SSLEC4PIN	10	4.12
Connectors				
	60	SSLC60	150	1.57
	100	SSLC100	75	2.49
Reducers				
Slotted	100x60	SSLR100X60Slot	75	8.22
Unslotted	100x60	SSLR100X60	75	8.11

Ridgiduct - Fittings

Description	Code	Pack Qty	Price (each)
94mm Black Coupling	RBC94	10	2.77
100mm Black Coupling	RBC100	10	3.52
125mm Black Coupling	RBC125	10	5.68
150mm Black Coupling	RBC150	10	5.05



For a sealed 94mm system order SRD94 seals and CRD94 couplings.
 For a sealed 100mm system order SRD100 seals and CRD100 couplings.
 For a sealed 150mm system order SRD150 seals and CRD150 couplings.



Ridgiduct Black Long Radius Drawn Bends

Description	Angle	Radius (mm)	Code	Pack Qty	Price (each)
94mm	11.25°	420	RBDB94X11X0.42	10	10.27
	22.5°	420	RBDB94X22X0.42	10	10.27
	45°	420	RBDB94X45X0.42	7	10.27
	90°	420	RBDB94X90X0.42	7	10.27
100mm	11.25°	420	RBDB100X11X0.42	10	12.15
	22.5°	420	RBDB100X22X0.42	10	12.15
	45°	420	RBDB100X45X0.42	7	12.15
	90°	420	RBDB100X90X0.42	7	12.15
125mm	11.25°	600	RBDB125X11X0.6	7	15.47
	22.5°	600	RBDB125X22X0.6	7	15.47
	45°	600	RBDB125X45X0.6	4	15.47
	90°	600	RBDB125X90X0.6	3	15.47
150mm	11.25°	610	RBDB150X11X0.61	5	20.37
	22.5°	610	RBDB150X22X0.61	5	20.37
	45°	610	RBDB150X45X0.61	4	20.37
	90°	610	RBDB150X90X0.61	3	20.37

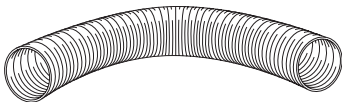

PLEASE ALLOW 3 DAYS FOR DELIVERY

PLEASE ALLOW 7 DAYS FOR DELIVERY

MADE TO ORDER ONLY

RIDGIDUCT - TWIN WALL DUCT

Ridgiduct Bends and Accessories

Ridgiduct bends are manufactured from uPVC ducting.

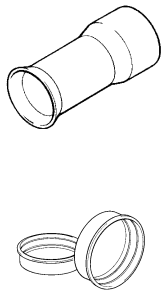
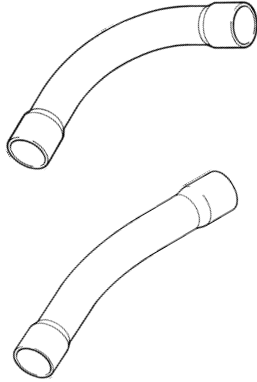

Description	Angle	Radius (m)	Code	Pack Qty	Price (each)	
uPVC Double Socket Bend	100mm	11.25°	2.4	RBB100X11X2.4	1	21.15
		22.5°	2.4	RBB100X22X2.4	1	21.15
		45°	0.45	RBB100X45X0.45	1	21.15
		90°	0.45	RBB100X90X0.45	1	21.15
	125mm	11.25°	2.4	RBB125X11X2.4	1	29.52
		22.5°	2.4	RBB125X22X2.4	1	29.52
		45°	0.61	RBB125X45X0.61	1	29.52
		90°	0.61	RBB125X90X0.61	1	29.52
	150mm	11.25°	2.4	RBB150X11X2.4	1	44.45
		22.5°	2.4	RBB150X22X2.4	1	44.45
		45°	0.61	RBB150X45X0.61	1	44.45
		90°	0.61	RBB150X90X0.61	1	44.45

Sealed Ridgiduct bends are available for 100 & 150mm duct.

Description	Size (mm)	Code	Pack Qty	Price (each)
Single Socket Fixed Bellmouth	94	RBBM94	1	6.15
	100	RBBM100	1	6.15
	125	RBBM125	1	9.96
	150	RBBM150	1	12.01
Plastic End Cap	94	RBEC94	1	2.20
	100	EC1059	1	2.43
	125	EC3051	1	2.91
	150	EC1778	1	5.85

* Made to order and are subject to minimum order quantities and lead times.

POLYDUCT

Polyduct - Black Electric Cable Duct

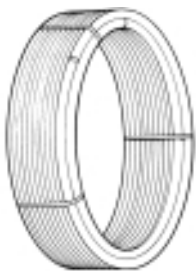

Order Couplers and Seals separately

	OD (mm)	ID (mm)	Length (m)	Code	Pack Quantity	Price per length	Price per metre
Printed Electric Cable Duct	37	32	100 coil	PD3237X100BEPE	1	100.45	1.00
	37	32	50 coil	PD3237X50BEPE	1	50.92	1.02
	37	32	25 coil	PD3237X25BEPE	1	26.07	1.04
	44	38	100 coil	PD3844X100BEPE	1	134.42	1.34
	44	38	50 coil	PD3844X50BEPE	1	68.12	1.36
	44	38	25 coil	PD3844X25BEPE	1	34.87	1.39
	60	50	50 coil	PD5060X50BEPE	1	131.77	2.64
	60	50	25 coil	PD5060X25BEPE	1	64.54	2.70

Other print options are available made to order, subject to minimum order quantities and lead times.

PLEASE ALLOW 3 DAYS FOR DELIVERY

PLEASE ALLOW 7 DAYS FOR DELIVERY

MADE TO ORDER ONLY

POLYDUCT

Polyduct Black Couplings						
Description	To suit duct measurements		Code	Pack Qty	Price each	
	ID (mm)	OD (mm)				
Couplings	32	37	PDC32	1	1.87	
	38	44	PDC38	1	1.91	
	50	60	PDC50	1	2.71	

Polyduct Orange Lighting						
Description	OD (mm)	ID(mm)	Length (m)	Code	Pack Qty	Price (each)
Printed Traffic Signal (TS)	60	50	6	PD5060X60(SL or TS)	250	15.51
Street Lighting (SL)	63	56	6	PD5663X60(SL or TS)	250	14.43
	107	100	6	PD100107X60(SL or TS)	85	29.80
	107	97	6	PD97107X60(SL or TS)	85	31.01

Polyduct Orange Lighting Bends						
Description	OD (mm)	Angle	Radius (mm)	Code	Pack Qty	Price (each)
Bends	60	45°	350	PDB60X450	25	6.10
	60	90°	225	PDB60X900	25	6.10
	63	45°	350	PDB63X450	25	6.10
	63	90°	225	PDB63X900	25	6.10
	107	45°	450	PDB107X450	1	10.73
	107	90°	450	PDB107X900	1	10.73

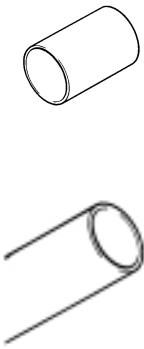

Polyduct is available in all NJUG colours, subject to minimum order quantities, lead times and priced on application.

RIDGICOIL

Ridgicoil - Black Electric Cable Duct							
Description	OD (mm)	ID (mm)	Length (m)	Code	Price per coil	Price per metre	
Printed Electric Cable Duct	40	31	50	RC40X50BE	63.95	1.28	
	50	40	50	RC50X50BE	73.79	1.48	
	63	50	50	RC63X50BE	91.83	1.84	
	75	60	50	RC75X50BE	129.55	2.59	
	90	71	50	RC90X50BE	145.94	2.92	
	110	94	50	RC110X50BE	196.78	3.94	
	160	140	25	RC160X25BE	229.58	9.18	

Other print options are available made to order, subject to minimum order quantities and lead times. 125mm is made to order only, subject to minimum order quantities and lead times.

Ridgicoil - Purple Motorway Comms.							
Description	OD (mm)	ID (mm)	Length (m)	Code	Price per coil	Price per metre	
Printed Motorway Communications / Power.	63	50	50	RC63X50PMCP	96.21	1.95	
	110	94	50	RC110X50PMCP	206.15	4.12	

Motorway Communications print and No print options are also available made to order, subject to minimum order quantities and lead times.

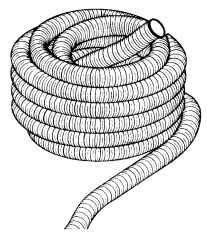

1 coupler supplied per coil

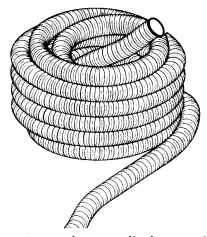

1 coupler supplied per coil

RIDGICOIL

Ridgicoil - Orange Lighting

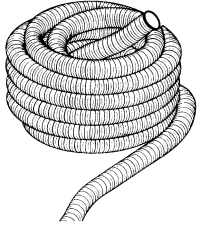

1 coupler supplied per coil

Description	OD (mm)	ID (mm)	Length (m)	Code	Price per coil	Price per metre
Printed Traffic Signal (TS) or Street Lighting (SL).	63	50	50	RC63X500(TS or SL)	96.21	1.92
	110	94	50	RC110X500(TS or SL)	206.15	4.12

90mm & other print options are available made to order, subject to minimum order quantities and lead times. Other sizes made to order.

Ridgicoil - Utilities

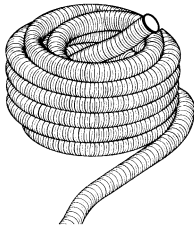

1 coupler supplied per coil

Description	OD (mm)	ID (mm)	Length (m)	Code	Price per coil	Price per metre
Water (Blue)	50	40	50	RC50X50BL	77.31	1.55
	63	50	50	RC63X50BL	96.21	1.92
	110	94	50	RC110X50BL	206.15	4.12

*Made to order, subject to minimum order quantities and lead times.

Ridgicoil - Utilities

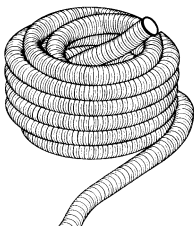

1 coupler supplied per coil

Description	OD (mm)	ID (mm)	Length (m)	Code	Price per coil	Price per metre
Gas (Yellow)	50	40	50	RC50X50Y	77.31	1.55
	63	50	50	RC63X50Y	96.21	1.92
	110	94	50	RC110X50Y	206.15	4.12

*Made to order, subject to minimum order quantities and lead times.

Ridgicoil - Utilities

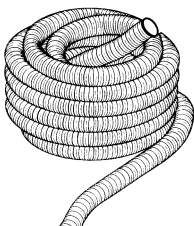

1 coupler supplied per coil

Description	OD (mm)	ID (mm)	Length (m)	Code	Price per coil	Price per metre
Telecommunications (Green)	63	50	50	RC63X50G	96.21	1.92
	110	94	50	RC110X50G	206.15	4.12

PLEASE ALLOW 3 DAYS FOR DELIVERY

PLEASE ALLOW 7 DAYS FOR DELIVERY

MADE TO ORDER ONLY

RIDGICOIL

Ridgicoil - Couplings

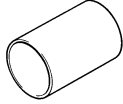

Description	OD (mm)	Code	Pack Qty	Price (each)
	40	RCC40	10	1.75
	50	RCC50	10	1.92
	63	RCC63	10	2.44
	75	RCC75	10	3.26
	90	RCC90	10	3.34
	110	RCC110	10	3.67
	160	RCC160	10	6.46

Ridgicoil - Seals



Description	OD (mm)	Code	Pack Qty	Price (each)
	40	RCS40	10	1.33
	50	RCS50	10	1.40
	63	RCS63	10	1.50
	75	RCS75	10	1.50
	90	RCS90	10	1.85
	110	RCS110	10	2.03
	160	RCS160	10	6.04

Draw Cords

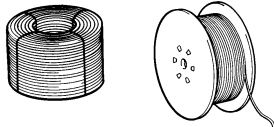

Description	Code	Pallet Qty	Price (each)
6mm diameter x 220m Draw Cord	DC220	240	13.05
6mm diameter x 500m Draw Cord (wooden drum) Nominal 5kN breaking strength	DC500	108	31.78

uPVC SPECIFICATION DUCTING

BS4660 Type Duct Non - Sealed (Dimensions Compliant Only)

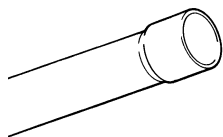

Grey to black in colour as standard. Colours available on request, made to order and subject to minimum order quantities and lead times.

Description	Dia (mm)	W.T.* (mm)	Code	Pack Qty	Price (each)
BS4660 Type Duct Non-Sealed in 6 metre lengths	110	3.2-3.5	SD110X6B	95	17.36
	160	4.1-4.7	SD160X6B	46	27.16
Bends	Dia (mm)	Angle	Code	Pack Qty	Price (each)
	110	11.25°	SDB110X11	1	12.70
	110	22.5°	SDB110X22	1	12.70
	110	45°	SDB110X45	1	12.70
	110	90°	SDB110X90	1	12.70
	160	11.25°	SDB160X11	1	30.87
	160	22.5°	SDB160X22	1	30.87
	160	45°	SDB160X45	1	30.87
Couplings	110		SDC110	1	2.99
	160		SDC160	1	4.24

PLEASE ALLOW 3 DAYS FOR DELIVERY

PLEASE ALLOW 7 DAYS FOR DELIVERY

MADE TO ORDER ONLY

uPVC SPECIFICATION DUCTING

BS4660 Type Duct Sealed (Dimensions Compliant Only)



Grey to black in colour as standard with other colours available on request.
* WT = Wall Thickness

Description	Dia (mm)	W.T.* (mm)	Code	Pack Qty	Price (each)
BS4660 Type Duct Sealed Plain Ended in 6 metre lengths	110	3.2-3.5	SD110X6BPE	95	17.36
	160	4.1-4.7	SD160X6BPE	46	27.16
Bends	110	45°	SDB110X45PE	1	P.O.A.
	110	90°	SDB110X90PE	1	P.O.A.
	160	45°	SDB160X45PE	1	P.O.A.
	160	90°	SDB160X90PE	1	P.O.A.
Couplings (polypropylene)	110		UG402B	1	4.11
	160		UG602B	1	8.65

uPVC GENERAL PURPOSE DUCT

uPVC General Purpose Duct and Fittings

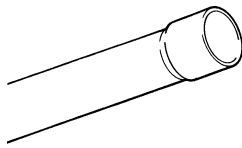

Grey to black in colour for both pipes and fittings.



Description	Dia (inches)	Dia (mm)	W.T. (mm)	Code	Pack Qty	Price per length	Price per metre
Ducts in 6 metre Straight Lengths	2"	54	1.5-1.7	GP2X6B	400	6.86	1.14
	3"	89	1.8-2.2	GP3X6B	144	10.03	1.67
	4"	114	1.8-2.1	GP4X6B	86	11.51	1.92
	6"	168	2.2-2.9	GP6X6B	36	20.93	3.49
	8"	200	3.2-3.6	GP8X6B	25	66.49	11.08
Description	Dia (inches)	Dia (mm)	Code	Pack Qty	Price (each)		
Bends	2	54	GPB2X11	60	3.62		
	2	54	GPB2X22	60	3.62		
	2	54	GPB2X45	60	3.62		
	2	54	GPB2X90	50	3.62		
	3	89	GPB3X11	25	4.03		
	3	89	GPB3X22	25	4.03		
	3	89	GPB3X45	15	4.03		
	3	89	GPB3X90	10	4.03		
	4	114	GPB4X11	10	5.01		
	4	114	GPB4X22	10	5.01		
	4	114	GPB4X45	10	5.01		
	4	114	GPB4X90	7	5.01		
	6	168	GPB6X11	3	11.64		
	6	168	GPB6X22	3	11.64		
	6	168	GPB6X45	3	11.64		
	6	168	GPB6X90	3	11.64		
8	200	GPB8X11	1	40.23			
8	200	GPB8X22	1	40.23			
8	200	GPB8X45	1	40.23			
8	200	GPB8X90	1	40.23			

PLEASE ALLOW 3 DAYS FOR DELIVERY

PLEASE ALLOW 7 DAYS FOR DELIVERY

MADE TO ORDER ONLY

uPVC GENERAL PURPOSE DUCT

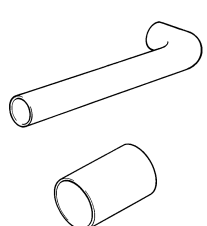
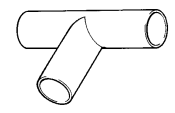
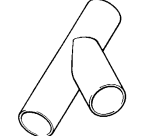
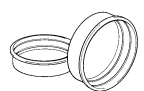
Description	Dia (inches)	Dia (mm)	Code	Pack Qty	Price (each)
 <p>Hockey Sticks*</p> <p>Connectors</p>	2"	54	GPHS2	25	5.06
	2"	54	GPC2	10	1.59
	3"	89	GPC3	60	2.40
	4"	114	GPC4	40	2.66
	6"	168	GPC6	15	2.95
 <p>90° Junctions Manufactured to order and subject to minimum order quantities and lead times</p>	2"	54	GPJT2X90	1	9.80
	3"	89	GPJT3X90	1	15.69
	4"	114	GPJT4X90	1	17.61
	6"	168	GPJT6X90	1	29.39
	8"	206	GPJT8X90	1	36.22
 <p>45° Junctions Manufactured to order and subject to minimum order quantities and lead times</p>	2"	54	GPJY2X45	1	9.80
	3"	89	GPJY3X45	1	15.69
	4"	114	GPJY4X45	1	17.61
	6"	168	GPJY6X45	1	29.39
	8"	206	GPJY8X45	1	36.22
 <p>End Caps</p>	2"	54	GPEC2	10	0.63
	3"	89	GPEC3	10	0.73
	4"	114	GPEC4	10	1.04
	6"	168	GPEC6	10	2.07
	8"	206	GPEC8	10	10.89

* Made to order and are subject to minimum order quantities and lead times.

SURETWIN GENERAL PURPOSE TWIN WALL DUCT

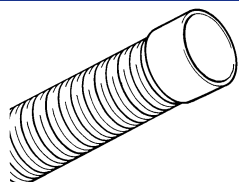
Suretwin General Purpose Twin Wall Duct and Fittings						
Description	ID (mm)	OD (mm)	Code	Pack Qty	Price per length	Price per metre
 <p>HDPE Twin Wall Ducting in 6 metre lengths</p> <p>For fittings please see Ridgiduct section.</p> <p>Suretwin has recently been relaunched for non BBA certified twin wall products meeting the stiffness and normal duty impact requirements of BS EN 50086-2-4. No other provisions of this standard are applicable to Suretwin products.</p> <p>1 coupler supplied per length</p>	150	178	GPT150X6B	36	32.09	5.35

YELLOW PERFORATED GAS DUCT

Gas Ducting				
Description	Nom. Size	Length (m)	Code	Price per length
Perforated Gas Duct (Yellow)	60	25	LD6025YGAS	23.07
	60	50	LD6050YGAS	46.11
	60	150	LD60150YGAS	138.72
	100	25	LD10025YGAS	61.20
	100	50	LD10050YGAS	122.42

PLEASE ALLOW 3 DAYS FOR DELIVERY

PLEASE ALLOW 7 DAYS FOR DELIVERY

MADE TO ORDER ONLY

uPVC UTILITY / TELECOMMS / CABLE TV DUCT

uPVC Utility Duct and Fittings

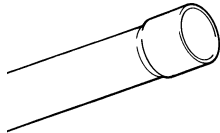

Available in 6 metre lengths, coloured green as standard. Other colours available on request. Minimum order quantities may apply.

Description	OD(mm)	W.T. (mm)	Standard	Code	Pack Qty	Price per length	Price per metre
Green Telecomms Duct	54	1.55-1.70	-	TD54X6G	400	13.77	2.30
	96	3.0-3.2	BSEN50086	TD96X6G	121	23.57	3.93
Grey Duct	96	3.0-3.2	BSEN50086	TD96X6GR	121	23.57	3.93
Black Duct	96	3.0-3.2	BSEN50086	TD96X6B	121	23.52	3.92

Bends



Description	Code	Pack Qty	Price (each)
54mm Green Bends	TDB54X11G	60	5.52
54mm bends also available in grey (GR) and black (B) Please add GR or B to the end of the code	TDB54X22G	60	5.52
	TDB54X45G	60	5.52
	TDB54X90G	50	5.52
	TDB96X11G	15	5.58
96mm Green Bends	TDB96X22G	15	5.58
	TDB96X45G	15	5.58
	TDB96X90G	10	5.58
	TDB96X11GR	15	5.58
96mm Grey Bends	TDB96X22GR	15	5.58
	TDB96X45GR	15	5.58
	TDB96X90GR	10	5.58
	TDB96X11B	15	5.58
96mm Black Bends	TDB96X22B	15	5.58
	TDB96X45B	15	5.58
	TDB96X90B	10	5.58

Couplings

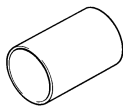

Description	Code	Pack Qty	Price (each)
54mm	TDC54G	10	1.83
54mm Slip Coupling	TDSC54G	10	1.86
96mm	TDC96G	50	2.53
96mm Slip Coupling	TDSC96G	50	3.37

Swept Tees

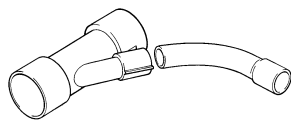

Description	Code	Pack Qty	Price (each)
96 x 54mm	TDJT96X54G	15	5.29

PLEASE ALLOW 3 DAYS FOR DELIVERY PLEASE ALLOW 7 DAYS FOR DELIVERY MADE TO ORDER ONLY

uPVC UTILITY / TELECOMMS / CABLE TV DUCT

End Caps (Plastic, inside fitting)

Description	Code	Pack Qty	Price (each)
54mm	EC1031	10	1.06
96mm	EC1055	10	1.32

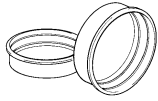

Repair Kits

Description	Standard Length (m)	Code	Pack Qty	Price (each)
96mm Duct Repair Kit	0.5	DRK096	1	22.21

Other lengths available on request

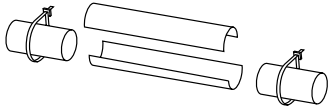

Hockey Sticks

Utility Provider	Nom. Size (mm)	Colour	Code	Pack Qty	Price (each)
Central Network	oval	white	HSPV019WHITE	25	5.79
EDF - Eastern	39	white	HSPV018WHITE	25	5.79
NEDL - Northern	39	white	HSPV018WHITES	25	5.79
Scottish Power	32	black	HSPV032BLACK	25	5.79
Scottish & Southern Power	38	black	HSPV017SEBBLK	25	5.79
Scottish & Southern Power	38	white	HSPV017WHITE	25	5.79
United Utilities	32	white	HSPV032WHITE	25	5.79
Western Power	37	white	HSPV016WHITE	25	5.79

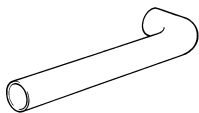

DUCTED ACCESS SYSTEMS

Ducted Access Boxes, Covers and Frames

Description	Height (mm)	Box Opening Width (mm)	Box Opening Depth (mm)	External Width (mm)	External Depth (mm)	Code	Price (each)
ACCESS BOXES							
290 x 275 Single Unit	320	325	310	390	375	AC2902751	24.47
290 x 275 Double Unit	650	325	310	390	375	AC2902752	48.97
290 x 275 Triple Unit	985	325	310	390	375	AC2902753	73.27
450 x 300 Single Unit	320	485	335	550	400	AC4503001	32.60
450 x 300 Double Unit	650	485	335	550	400	AC4503002	65.22
450 x 300 Triple Unit	985	485	335	550	400	AC4503003	97.83
450 x 450 Single Unit	320	470	470	550	550	AC4504501	38.04
450 x 450 Double Unit	650	470	470	550	550	AC4504502	76.09
450 x 450 Triple Unit	985	470	470	550	550	AC4504503	114.12
600 x 450 Single Unit	320	635	485	700	550	AC6004501	50.13
600 x 450 Double Unit	650	635	485	700	550	AC6004502	100.24
600 x 450 Triple Unit	985	635	485	700	550	AC6004503	150.74
600 x 600 Single Unit	320	635	635	700	700	AC6006001	54.35
600 x 600 Double Unit	650	635	635	700	700	AC6006002	108.71
600 x 600 Triple Unit	985	635	635	700	700	AC6006003	163.04

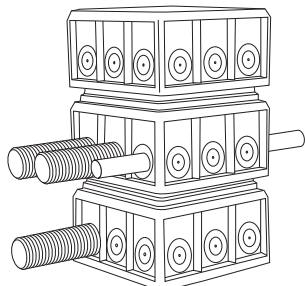

PLEASE ALLOW 3 DAYS FOR DELIVERY

PLEASE ALLOW 7 DAYS FOR DELIVERY

MADE TO ORDER ONLY

DUCTED ACCESS SYSTEMS

Ducted Access Boxes, Covers and Frames

Description	Height (mm)	Box Opening (mm)		External (mm)		Code	Price (each)
		Width	Depth	Width	Depth		

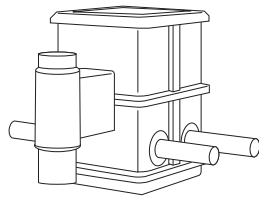

POLE BOXES

290 x 275 for 114mm pole	615	325	310	680	400	PB2902751	55.26
290 x 275 for 140mm pole	615	325	310	680	400	PB2902752	55.26
450 x 450 for 114mm pole	605	470	470	875	600	PB4504501	70.50
450 x 450 for 140mm pole	605	470	470	875	600	PB4504502	70.50

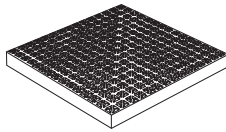

COMPOSITE COVERS

290 x 275						CC290275	60.55
450 x 300						CC450300	70.95
450 x 450						CC450450	94.36
600 x 450						CC600450	117.01
600 x 600						CC600600	135.87

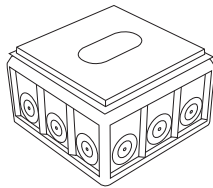

COMPOSITE COVER FRAMES NON-LOCKING GALVANISED STEEL FRAMES

290 x 275						CCF290275	30.95
450 x 300						CCF450300	34.11
450 x 450						CCF450450	37.75
600 x 450						CCF600450	41.54
600 x 600						CCF600600	45.28

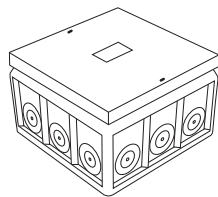

COMPOSITE COVER FRAMES LOCKING GALVANISED STEEL FRAMES

290 x 275						CCF290275L	38.51
450 x 300						CCF450300L	41.66
450 x 450						CCF450450L	45.28
600 x 450						CCF600450L	49.07
600 x 600						CCF600600L	52.85

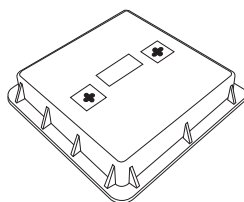

GALVANISED STEEL COVERS & FRAMES

290 x 275						GCF290275	81.10
450 x 300						GCF450300	96.03
450 x 450						GCF450450	131.05
600 x 450						GCF600450	168.34
600 x 600						GCF600600	227.98

DUCTILE IRON COVERS & FRAMES

450 x 450						DCF450450	164.71
600 x 450						DCF600450	107.04
600 x 600						DCF600600	150.97

FIELDcoil LAND DRAINAGE PIPES AND FITTINGS

BS4962

Polypropylene Fieldcoil Land Drainage Pipes (Available black only)

Description	Length (m)	Code	Price per m	Price (each)
60mm perforated	25	SP6025		P.O.A
	50	SP6050		P.O.A
	150	SP60150		P.O.A
60mm unperforated	150	SU60150		P.O.A
80mm perforated	25	SP8025		P.O.A
	50	SP8050		P.O.A
	100	SP80100		P.O.A
80mm unperforated	100	SU80100		P.O.A
100mm perforated	25	SP10025		P.O.A
	50	SP10050		P.O.A
	100	SP100100		P.O.A
100mm unperforated	100	SU100100		P.O.A
160mm perforated	40	SP16040		P.O.A
160mm unperforated	40	SU16040		P.O.A

Refer to page 10 for Types 6, 8, & 9

Sizes shown for land drainage pipes are outside diameters.

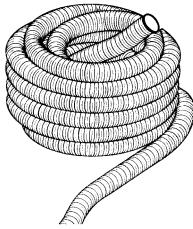

1 coupling supplied per coil.

268mm pipe available from stock. 350mm manufactured to order and subject to lead times.

HDPE land drainage pipes are supplied plain ended. Use CRD225 couplings to join 268mm and CRD300 coupling to join 350mm. See page 3. Couplings should be ordered separately.

HDPE Land Drainage Pipes (Available black only)

Description	Length (m)	Code	Price per m	Price (each)
268mm perforated	30	LD26030		P.O.A
268mm unperforated	30	UD26030		P.O.A
350mm perforated	6	LD3506		P.O.A
350mm unperforated	6	UD3506		P.O.A

Fittings

Description	Size	Pack Qty	POLYPROPYLENE		uPVC	
			Code	Price (each)	Code	Price (each)
Connector	60mm	10	C60	P.O.A	DC60	1.62
	80mm	10	C80	P.O.A	DC80	1.82
	100mm	10	C100	P.O.A	DC100	2.05
	125mm	30	-	P.O.A	DC125	2.46
	160mm	10	C160	P.O.A	DC160	2.82
	200mm	8	-	P.O.A	DC200	10.63

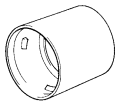

PVC - Blue
Polypropylene - Black
HDPE - Black

Description	Size	Pack Qty	POLYPROPYLENE		uPVC	
			Code	Price (each)	Code	Price (each)
End Cap	60mm	10	HECPP60	P.O.A	HEC60	1.44
	80mm	10	HECPP80	P.O.A	HEC80	1.82
	100mm	10	HECPP100	P.O.A	HEC100	2.05
	125mm	10	HECPP110	P.O.A	HEC125	2.82
	160mm	10	HECPP160	P.O.A	HEC160	2.55
	200mm	10	-	P.O.A	HEC200	P.O.A.

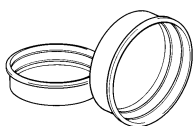

Colours may vary, may be red, blue or green.

PLEASE ALLOW 3 DAYS FOR DELIVERY

PLEASE ALLOW 7 DAYS FOR DELIVERY

MADE TO ORDER ONLY

LANDCOIL LAND DRAINAGE PIPES AND FITTINGS

Outfall Pipe Available in 1.5 metre lengths. (Black or blue state with order)

Outfall pipes are manufactured to order and subject to lead times.



Description	Pack Qty	Code	Price (each)
60mm	10	HOP60	4.36
80mm	10	HOP80	6.54
100mm	10	HOP100	9.60
125mm	10	HOP125	11.33
160mm	5	HOP160	15.31



Sizes shown for land drainage pipes are outside diameters.

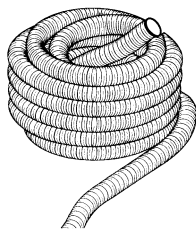

Available in blue. Yellow manufactured to order and subject to minimum order quantities and lead times.

Refer to page 10 for Types 6, 8, & 9

uPVC Landcoil Land Drainage Pipes

Description	Length (m)	Code	Price per m	Price (each)
60mm perforated	25	LD6025B	0.80	20.09
	50	LD6050B	0.80	40.18
	150	LD60150B	0.71	107.09
60mm unperforated	150	UD60150B	0.71	107.09
80mm perforated	25	LD8025B	1.21	30.15
	50	LD8050B	1.21	60.31
	100	LD80100B	1.07	107.09
80mm unperforated	100	UD80100B	1.07	107.09
100mm perforated	25	LD10025B	2.13	53.13
	50	LD10050B	2.12	106.24
	100	LD100100B	1.89	188.67
100mm unperforated	100	UD100100B	1.89	188.67
125mm perforated	75	LD12575B	3.40	254.95
125mm unperforated	75	UD12575B	3.40	354.95
160mm perforated	25	LD16025B	4.98	124.44
	45	LD16045B	4.42	198.86
160mm unperforated	45	UD16045B	4.42	198.86
200mm perforated	40	LD20040B	9.35	373.96
200mm unperforated	40	UD20040B	9.35	373.96

Land Drainage Fittings

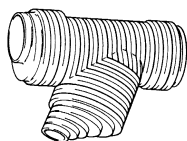

Description	Code	Pack Qty	Price (each)
Junctions			
60mm to 60mm diameter blue uPVC Y Junction	CDJ66	140	3.43
80mm to 100mm diameter blue uPVC Multi-Junction	CDJ10M	30	5.35
160mm to 60mm diameter black uPVC Multi-Junction	CDJ160M	8	10.22
80mm to 100mm diameter black PP Multi-Junction	CDJ100M	50	4.63

PLEASE ALLOW 3 DAYS FOR DELIVERY

PLEASE ALLOW 7 DAYS FOR DELIVERY

MADE TO ORDER ONLY

POLYDRY

Polydry Horizontal Ducts and Fittings

Description	Length (m)	Code	Price per length	Price per metre
225mm plain ended Polydry duct	6	PY225X6PE	118.81	19.80
300mm plain ended Polydry duct	6	PY300X6PE	155.15	25.86
450mm plain ended Polydry duct	6	PY450X6PE	401.94	66.99
600mm plain ended Polydry duct	6	PY600X6PE	528.49	88.09

Codes shown are for perforated pipes only. For unperforated pipes insert 'S' in the product code, e.g. PY225X3SPE for unperforated 225mm Polydry pipes in 3m lengths.
 *Made to order, subject to minimum order quantities and lead times.

Polydry Horizontal Fittings

Description	Size (mm)	Code	Price (each)
Polydry Spigot air door	225	PY225SAD	59.88
	300	PY300SAD	94.82
	450	PY450SAD	112.30
	600	PY600SAD	185.46
Polydry Anti-roll coupler	225	PY225C	21.19
	300	PY300C	29.58
	450	PY450C	54.89
	600	PY600C	59.88
Polydry End Cap	225	PY225EC	16.35
	300	PY300EC	19.96
	450	PY450EC	33.66
	600	PY600EC	62.38

Polydry Vertical Pedestals

Description	Size (mm)	Code	Price (each)
1.2m x 300mm lower section to 2 x 1m x 150mm extension pipes	300 to 150	PYV3001502	192.94
1.2m x 450mm lower section to 3 x 1m x 150mm extension pipes	450 to 150	PYV4501503	282.98

Polydry Vertical Extensions

Description	Size (mm)	Length (m)	Code	Price (each)
Polydry unperforated extension pipe	150	1	PYV150X1	7.45
	150	2	PYV150X2	14.89
Coupling	150	-	CRD150	6.18
Polydry 240V Fan, single phase, 50Hz for 150mm extension ducts			VBW7	683.00
Polydry 415V Fan, three phase, 50Hz for 200mm extension ducts			VBW9	935.07

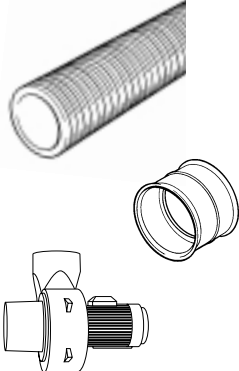
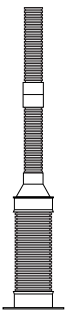
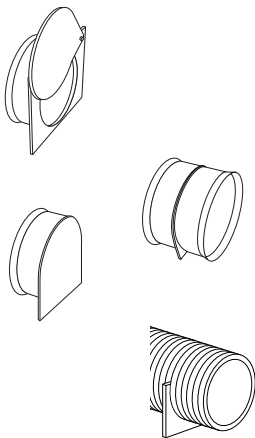

PLEASE ALLOW 3 DAYS FOR DELIVERY

PLEASE ALLOW 7 DAYS FOR DELIVERY

MADE TO ORDER ONLY

AGRITWIN

Agritwin Pipe

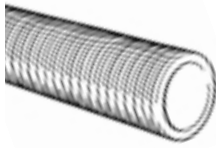

- 150 - 375mm supplied plain ended
- 400 - 600mm supplied integrally socketed
- Order Ridgidrain couplings and fittings separately as required
- Half perforated Agritwin may also be subject to minimum order quantities and lead times

Nom. Size	Code	Code Half Perf	Code Perf	Quantity	Price per length	Price per metre
150	AT150X6PE			36	17.10	2.85
150		AT150X6PEHP		36	17.27	2.88
150			AT150X6PEP	36	17.27	2.88
225	AT225X6PE			14	47.12	7.85
225		AT225X6PEHP		14	47.57	7.93
225			AT225X6PEP	14	47.57	7.93
300	AT300X6PE			9	71.35	11.89
300		AT300X6PEHP		9	72.03	12.01
300			AT300X6PEP	9	72.03	12.01
375	AT375X6PE			5	174.45	29.08
375			AT375X6PEP	5	176.11	29.35
400	AT400X6			5	244.90	40.82
400			AT400X6P	5	247.23	41.21
450	AT450X6			1	262.40	43.73
450			AT450X6P	1	264.89	44.15
500	AT500X6			1	314.87	52.48
500			AT500X6P	1	317.87	52.98
600	AT600X6			1	415.11	69.19
600			AT600X6P	1	419.06	69.84

ANCILLARY PRODUCTS

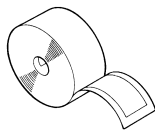
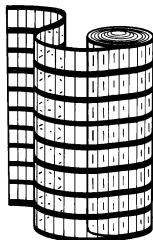

Description	Size	Code	Pack Qty	Price (each)
High Visibility Fencing Available in orange, blue, yellow & green in 1m x 50m rolls Manufactured to order and subject to minimum order quantities and lead times.	5.5kg	FNHVEFN5.5	60	26.48
	8kg	FNHVEFN8	50	37.54
	10kg	FNHVEFN10	40	46.95
	12.5kg	FNHVEFN12.5	40	52.24
	14kg	FNHVEFN14	40	56.98
Cable Guard Supplied in 10 foot lengths	0.5" diameter	CG001X10	50	6.87
	0.75" diameter	CG002X10	25	7.78
	1" diameter	CG003X10	25	9.52
	1.5" diameter	CG004X10	10	13.46
	2" diameter	CG005X10	10	16.28
	2.5" diameter	CG006X10	10	19.76
	3" diameter	CG007X10	5	31.76
Service Protection Markers MDPE TILE to ESI 12-23	40m length 200mm width printed "Electric Cables"	PPTT200	30	69.11
	40m length 150mm width printed "Electric Cables"	PPTT150	30	55.30

Manufactured to order and subject to minimum order quantities and lead times.

ECO-VAT

Eco-Vat Rainwater Harvesting Systems

Description	Description	Code	Price (each)	
Tanks	1500 litre primary storage tank	ECVT1.5	P.O.A.	
	3000 litre primary storage tank	ECVT3	P.O.A.	
	5000 litre primary storage tank	ECVT5	P.O.A.	
	3000 litre add on tank	ECVT3ADD	P.O.A.	
	5000 litre add on tank	ECVT5ADD	P.O.A.	
	12000 litre GRP primary storage tank	ECVT12	P.O.A.	
	13600 litre GRP primary storage tank	ECVT13.6	P.O.A.	
	15000 litre GRP primary storage tank	ECVT15	P.O.A.	
	18000 litre GRP primary storage tank	ECVT18	P.O.A.	
	22500 litre GRP primary storage tank	ECVT22.5	P.O.A.	
	27000 litre GRP primary storage tank	ECVT27	P.O.A.	
	36000 litre GRP primary storage tank	ECVT36	P.O.A.	
	45000 litre GRP primary storage tank	ECVT45	P.O.A.	
	54000 litre GRP primary storage tank	ECVT54	P.O.A.	
	80000 litre GRP primary storage tank	ECVT80	P.O.A.	
	3000 litre Water storage tank above ground	WST3A	P.O.A.	
	5000 litre Water storage tank above ground	WST5A	P.O.A.	
	Boxed Components	1500 litre irrigation component	ECV1/1.5	912.02
		3000 litre irrigation component	ECV1/3	1083.98
		Gravity component	ECVG-A	2373.52
Pressurised component		ECVP-A	2373.52	
5000 litre irrigation component		ECV1/5	1212.77	
6000 - 13600 litre irrigation component		ECV1/6/13.6	1290.60	
18000 - 80000 litre irrigation component		ECV1/18/80	1332.91	
Accessories		Standard leaf filter	ECVLF	91.21
	Vortex first flush filter up to 200m ²	ECVLF100	496.19	
	Vortex first flush filter up to 500m ²	ECVLF150	579.12	
	Vortex first flush filter up to 3000m ²	ECVLF300	2845.52	
	0.5m extension turret for leaf filter to 200m ²	ECVLF100ET	146.53	
	0.5m extension turret for leaf filter to 500m ²	ECVLF150ET	146.53	
	1m extension turret for leaf filter to 3000m ² *	ECVLF300ET	790.87	
	Extended lifting handle for LF100/LF150	ECVLFEXTLH**	146.53	
	Extended lifting handle for LF300	ECVLFEXTLH**	176.68	
	PVC UV filter 8 litres/minute	ECVUVIP15N	793.71	
	PVC UV filter 19 litres/minute	ECVUVIP30N	1051.58	
	PVC UV filter 54 litres/minute	ECVUVIP55N	1581.64	
	Stainless steel UV filter 54 litres/minute	ECVUVIS55N	P.O.A.	
	450 litre header tank	ECV450H	910.19	
	Overflow management system	ECV/OMS/3	978.04	
	220 micron floating filter	10005A	178.76	
	Riser for 3000 & 5000l Eco-Vat tank	UG431	27.33	
Riser seal	UG488	2.84		
Marker tape for reclaimed water pipework	ECVMT	6.29		
120 micron inline filter	10033	41.67		

System Selection

A complete system will include the following items:

- Tank, sized appropriately
- Components to suit, depending on application
 - Irrigation system
 - Gravity system
 - Pressurised system
- Leaf filter appropriate for roof area
- Optional UV Filter
 - for use where additional treatment is required

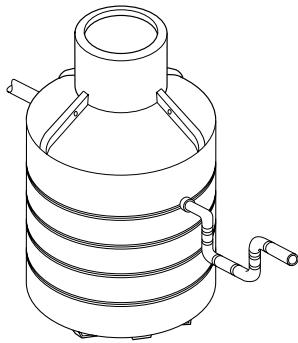

3000 & 5000 litre polyethylene tank.

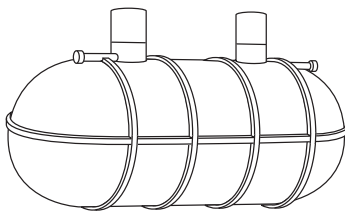

3000 litre and larger GRP tanks.



3000 and 5000 litre systems only

A full list of Eco-Vat spares is available on request. Please contact the technical office.

* Length to suit customer specification

** Append either 100, 150 or 300 to the product code



NOTES

A large rectangular area with a blue border, containing numerous horizontal blue lines for writing notes.



NOTES

A large rectangular area with a blue border, containing numerous horizontal blue lines for writing notes.

CONDITIONS OF SALE - APRIL 2003

GENERAL

1.1 In these conditions "the Company" shall mean Polypipe Civils Limited and "the Products" shall mean all goods and services and associated documentation to be supplied under this Contract. "Writing" includes telex, cable, facsimile transmission, electronic data transfer and comparable means of communication. All quotations are made and all orders are accepted subject to these conditions. All other terms conditions or warranties whatsoever are excluded from the contract or any variation thereof unless expressly accepted by the Company in Writing (order acknowledgments do not constitute such acceptance). In particular, in no circumstances will any conditions of purchase submitted at any time by the Customer be applied to this or any other Contract and any failure by the Company to challenge any such conditions of purchase does not imply acceptance of those conditions of purchase. In the event of a conflict between these conditions and the specific terms and conditions of quotation then the latter shall prevail. Acceptance by the Customer of delivery of the Products shall be deemed to constitute unqualified acceptance of these conditions.

1.2 Unless otherwise stated herein quotations shall be available for acceptance for a maximum period of 30 days from issue and may be withdrawn at any time by written or oral notice.

1.3 Any statement or representation (other than in the Company's quotation or order acknowledgement) by the Company its servants or agents upon which the Customer wishes to rely must be set out in Writing and attached to or endorsed on the Customer's order and in any such case the Company may confirm, reject or clarify the point and submit a new quotation. Any statement or representation which is not so confirmed in Writing is followed or acted upon entirely at the Customer's own risk.

1.4 The contract is between the Company and the Customer as principals; neither the benefit nor the burden is assignable by the Customer without the Company's written consent; the contract may be assigned or subcontracted by the Company.

1.5 Unless specifically agreed to the contrary all trade terms shall be interpreted in accordance with current INCOTERMS.

1.6 If, subsequent to any contract of sale which is subject to these conditions, a contract of sale is made with the same Customer without reference to any conditions of sale or purchase, such contract however made shall be deemed to be subject to these conditions or (if different) the standard Conditions of Sale of the Company current at the time when such contract of sale is made.

ELECTRONIC TRADING

2.1 If the Company and Customer agree that electronic trading between them shall be a basis for order processing and invoicing then the Standard Interchange Agreement (3rd Edition December 1993 as amended or revised from time to time) of the Electronic Commerce Association (or any successor body or association) shall be incorporated into the contract by reference. If and to the extent of any conflict or inconsistency between these conditions and the Standard Interchange Agreement, the former shall prevail.

2.2 Electronic orders shall be valid if all the information agreed between the Customer and the Company as being required is properly set out in the agreed format and the order is transmitted by the Customer to the Company by reference to the correct identification code and is received by the Company when collecting its electronic mail from the relevant system.

2.3 Each valid electronic order will be deemed accepted by the Customer unless the Company communicates rejection of the order to the Customer by electronic or other means (including telephone) within two working days of receipt. Acceptance of an order shall constitute a contract for sale and purchase to which these conditions and the Standard Interchange Agreement shall apply.

DELIVERY

3.1 Unless otherwise agreed in Writing by the Company delivery shall be deemed to take place in the case of ex works sales when the Products are made available by the Company for collection by the Customer or its carrier and in all other cases upon delivery by the Company to the agreed mainland UK delivery point airport or port but before the Products are unloaded, which shall be the responsibility of the Customer.

3.2 The Company shall not be obliged to make delivery unless until the Company has received all necessary information drawings final instructions and approvals from the Customer and any delays or alterations by the Customer may result in delayed delivery for which the Company shall not be responsible.

3.3 All dates and periods for delivery are estimated and do not constitute fixed times for delivery by the Company. Unless otherwise expressly agreed in Writing by the Company the Customer shall have no right to damages or to cancel the contract for failure arising from any cause to meet any delivery times given in the contract or subsequently set.

3.4 Notwithstanding Clause 3.3 the Customer shall be obliged to accept delivery on the date or within the period stated in the quotation or order or acknowledgement or (if none is so stated) in the order or (if none is so stated) one month after the issue or notice in Writing by the Company requiring the Customer to accept delivery. Failure by the Customer either to take delivery or to make payment in respect of any one or more instalments of Products shall entitle the Company to terminate the Contract (such right is without prejudice to any other rights and remedies available to the Company) whether expressly provided for in these Conditions or implied by any rule of law.

3.5 Where the Customer requests and the Company agrees to postpone delivery or where delivery is otherwise postponed without default by the Company the Customer shall pay upon receipt of written demand from the Company all costs and expenses including a reasonable charge for storage and transportation occasioned thereby and the Customer shall pay for the Products in accordance with these conditions as if the same had been delivered in the ordinary course without reference to the postponement. In addition, the Company shall be entitled to claim interest pursuant to Clause 7.3.2 of these Conditions from the date on which payment would have fallen due, had the Products been delivered in the ordinary course but for the postponement.

3.6 Unless otherwise expressly agreed in Writing the Company may effect delivery in one or more instalments. Where delivery is effected by instalments each instalment shall be treated as a separate contract governed by these conditions. No delay in the delivery of any instalment of Products or any defect therein shall entitle the Customer to terminate the remainder of the contract.

RISK AND TITLE

4.1 Risk of damage to or loss of the Products shall pass to the Customer upon delivery and the Customer is then solely responsible for all loss damage or deterioration to the Products.

4.2 Title to the Products shall not pass to the Customer until either:

4.2.1 The Company has received in cash or cleared funds all monies payable (whether or not due) to the Company under this and any other contracts whenever made between the Company and the Customer including contracts made after this contract; or

4.2.2 When the Company serves on the Customer notice in Writing specifying that title in the Products or any part thereof has passed.

4.3 Until title has passed to the Customer the Company may require the Customer to deliver up to the Company all products in respect of which the Company has title and if the Customer fails to do so forthwith the Company's officers, employees, representatives or agents shall be entitled to enter upon any premises where such Products are kept for the purposes of recovering the same.

4.4 Until title to the Products has passed to the Customer pursuant to these conditions it shall possess the Products as fiduciary agent and bailee of the Company and shall store the Products separately from other goods not owned by the Company and shall ensure that they are fully insured on all risks basis and clearly identifiable as belonging to the Company and the Company shall be entitled to enter upon any premises where such Products are kept for the purpose of satisfying itself that this condition is being complied with by the Customer.

4.5 In the event that the Customer has any contract with any other company under the ultimate control of the parent company that has ultimate control of the Company under which any monies are outstanding (whether or not due) then the Customer shall not (notwithstanding that title would otherwise pass pursuant to Clause 4.2 above) obtain title to the Products or other goods supplied by the Company under this or any other contracts between them until such other company has received in cash or cleared funds all such monies.

CANCELLATION AND AMENDMENT

5 No contract can be amended or cancelled except with the Company's approval in Writing and should such approval be given the Customer shall indemnify the Company against any costs, losses or expenses resulting from any cancellation or amendment.

PRICES

6.1 Unless otherwise agreed in Writing all prices are net for delivery ex works and VAT and any other applicable taxes are payable in addition. Unless otherwise stipulated by the Company in Writing prices are payable in Sterling or if the Sterling currency shall cease to exist when the contract is made, shall be payable in such currency as replacing the Sterling currency.

6.2 The Company shall be entitled at any time by giving notice in Writing, before or at the final invoice to make a reasonable adjustment to the price in the event of any alteration in quantity, design or specification requested by the Customer.

6.3 The Company reserves the right at any time prior to delivery by giving notice in Writing to increase the price if there is an increase in the cost of materials labour transport or utilities or if the costs of the Company are increased by any other factor beyond the reasonable control of the Company.

6.4 Charges made on the Company's invoice for cases will be credited on their return to the Company's premises carriage paid and in good reusable condition. Cases shown as returnable but not charged on the Company's invoice must be returned to the Company's premises carriage paid and in good re-usable condition otherwise an additional charge will be made in respect of their cost.

6.5 The Customer shall be liable to the Company for any demurrage costs incurred in the event of vehicles being unduly delayed at the point of delivery.

TERMS OF PAYMENT

7.1 Unless otherwise agreed by the Company in Writing, payment shall be made by the last day of the month following the month of invoice and the Company shall be entitled to issue invoices in the month in which the Products are delivered or would have been delivered, save for postponement otherwise than due to default on the part of the Company. Time for payment of the price is of the essence of the contract.

7.2 No disputes arising under this contract shall serve to prevent payment by the Customer of sums due to the Company to be delayed nor shall disputes interfere with prompt payment in full. The Buyer shall not be entitled to make any deduction from sums owing to the Company by reason of any such dispute.

7.3 In the event of default in payment by the Customer the Company shall be entitled without prejudice to any other right or remedy:

7.3.1 To suspend without notice all further deliveries on this or any other contracts between the Company and the Customer;

7.3.2 To charge interest on a daily basis (after as well as before judgement) on any amount outstanding at the rate of 4% above the Base Rate of Lloyds Bank plc from time to time; and/or

7.3.3 To serve notice on the Customer requiring immediate payment for all goods supplied by the company under this and all other contracts between them whether or not payment is otherwise due or invoiced.

SPECIFICATIONS

8.1 Subject to Clause 8.2 the Products shall in all material respects be of such specification agreed between the Company and the Customer under the contract, or (if not so agreed) shall be generally in all material respects in accordance with any published specification issued by the Company.

8.2 The Company reserves the right to make changes in dimensions or other specifications of the Products as are required to conform to applicable standards or laws or are otherwise within reasonable limits having regard to the nature of the Products. Dimensions specified by the Company are to be treated as approximate only unless it is specifically agreed in Writing that exact measurements are required.

LOSS SHORTAGES AND DAMAGE APPARENT ON DELIVERY INSPECTIONS

9.1 The Customer shall have no claim for loss, shortages or damage on delivery which are or would be apparent on inspection unless the Customer:

9.1.1 Unpacks and inspects the Products as soon as reasonably practicable after receipt;

9.1.2 Notifies the Company of any loss, shortages or damage (otherwise than by a qualified signature on the delivery note) within ten working days of receipt; and

9.1.3 Demonstrates to the satisfaction of the Company that such loss, shortages or damage occurred prior to delivery.

9.2 The Customer shall have no rights in respect of loss shortages or damage unless the Company is given a reasonable opportunity to inspect the Products and investigate any complaint before any use of or alteration to or interference with the Products.

9.3 On a valid complaint made in accordance with this Clause the Customer shall be entitled (in the case of notified shortages) to receive within a reasonable time a delivery of Products equivalent to the shortfall and (in the case of defects) to repairs to or replacements for the affected Products or at the Company's option a credit for the price thereof but the Company shall have no further liability whatsoever. If a complaint of loss shortages or damage on delivery is not made to the Company in accordance with this Clause 9 then the Products shall be deemed to be delivered complete and undamaged in accordance with the contract and the Customer shall be bound to pay for the same accordingly.

9.4 Loss shortages or damage in a delivery or any instalment delivery shall not be a ground for termination of the contract or the remainder of the contract (as the case may be).

WARRANTY

10.1 The Company warrants that Products which do not comply with either Clause 8.1 or Sections 13 to 15 of the Sale of Goods Act 1979 (as amended by the Sale and Supply of Goods Act 1994) or are shown to have been defective at delivery as a result of faulty design workmanship or materials (other than free-issue materials), shall either be repaired or replaced or that, at the Company's option, a credit or refund for the price thereof shall be given provided always that:

10.1.1 The Company receives written notice of the defect within 12 months of delivery;

10.1.2 No alteration to or interference with the Products takes place before the Company is given access to the Products to inspect and test the same;

10.1.3 The defect does not consist of a loss shortage or damage to which Clause 9 is expressed to apply;

10.1.4 The defect does not arise by reason of a design specification or instruction given by the Customer;

10.1.5 The Customer has not defaulted in its obligation to make payment of the contract price for the Products;

10.1.6 The defect shall not be attributable to incorrect storage or use of the Products by the Customer.

10.2 The benefit of Clause 10.1 shall only extend to Products or parts not manufactured by the Company to the extent that the Company has equivalent recourse against the manufacturer or supplier thereof.

10.3 The Customer shall indemnify the Company in respect of loss or damage arising from any use made of Products after the Customer became or ought reasonably to have been aware of a defect.

10.4 In the event of a valid claim being made in accordance with Clause 10.1:

10.4.1 The Customer shall be bound to accept repaired or replacement Products or at the Company's option credit or payment and shall not be entitled to terminate the contract;

10.4.2 If the Company does not repair or replace Products within 60 days or such longer time as may be reasonable then the Customer's sole remedy shall be an entitlement to full credit or repayment in respect of the defective Products; and the Company shall be under no further liability in respect of any loss or damage arising from the defect or from any delay before repair replacement credit or refund is effected.

LIABILITY

11.1 The Company does not exclude liability arising under Section 12 of the Sale of Goods Act 1979 (good title) (as amended by the Sale and Supply of Goods Act 1994) or for death or personal injury caused by its negligence as defined in the Unfair Contract Terms Act 1977.

11.2 Save as provided under Clauses 9, 10 and 11.1 the Company shall have no liability to the Customer in connection with or arising from any defect or failure in the Products or otherwise due to the quality condition suitability durability safety or any other aspect or feature of the Products. Save for death or personal injury attributable to the proven negligence of the Company, the Company's liability, whether in respect of one claim or in the aggregate, shall not exceed the contract price payable under this contract for the supply of Products to be provided under it. The Customer acknowledges that the limitation of the Company's liability is reasonable in all the circumstances and the Customer agrees that it is its own responsibility to insure adequately to cover any loss or damage in excess of the aforesaid limit of the Company's liability. Subject to reaching agreement on terms, the Company and the Customer may determine an increased level of liability which is to be accepted in Writing by the Company to cover, in particular specific types of loss or damage which both parties reasonably foresee and anticipate.

11.3 In Clause 11.2 the term "liability" means any form of liability whatsoever including but not limited to liability in misrepresentation and under contract common law equity and any statutory provision whether or not based on negligence or breach of any express or implied duty to act with care or skill.

11.4 Notwithstanding any other provisions of these conditions the Customer shall have no claim against the Company in respect of any loss other than strictly direct losses (meaning for these purposes the increased costs of purchasing products from a third party or the cost of remedial repair work) and specifically consequential, financial economic loss whether direct or indirect including but not limited to any incidental costs of dismantling fitting or other ancillary work required in connection with the provision of a repair or replacement, any loss of production profits contracts loss of use or anticipated savings and any claims made against the Customer by any third party are excluded even if reasonably foreseeable.

11.5 To the extent that any liability of the Company is expressed to be limited or excluded by these conditions the Customer shall indemnify the Company in respect thereof.

CONFIDENTIAL INFORMATION ETC

12 All drawings documents records computer software and other information supplied by the Company are supplied on the express understanding that copyright is reserved to the Company and that the Customer will not without written consent of the Company either give away loan exhibit or sell the same or extracts therefrom or copies thereof or use the same in any way except in connection with the Products in respect of which they are issued.

PATENT INDEMNITIES

13.1 If the Customer is subject to a claim or threatened with any action alleging that the Products in the form supplied infringe any patent copyright design right or other intellectual property rights then provided that the Customer promptly informs and fully co-operates with the Company and if requested allows the Company to conduct and defend the proceedings on the Customer's behalf, the Company will indemnify the Customer against any award or damages for infringement made in any such action by a court or other competent body against the Customer. Further, if the Products are infringing the Customer agrees that the company shall have the option at its own expense either to modify the Products so that they do not infringe or to replace the Products with a non-infringing substitute or to procure for the Customer the right for the Customer to continue its use of the Products or to repurchase the Products from the Customer at the price paid by the Customer less an allowance for the use made thereof.

13.2 The Company shall have no liability in respect of claims for infringement or alleged infringement of third parties patent or other intellectual property rights arising from the manufacture or supply of the Products to the Customer's instructions or in accordance with design plans or specifications given by the Customer and the Customer shall indemnify the Company against all losses damages expenses costs or other liability arising from such claims.

CUSTOMER'S DRAWINGS

14 The Customer shall be solely responsible for ensuring that all drawings information advice and recommendations provided or given to the Company by the Customer or its agents, servants consultants or advisers are accurate correct and suitable. Examination or consideration by the Company of such drawings information advice or recommendations shall not result in any liability on the part of the Company.

COMPANY LITERATURE

15 The information contained in the advertising sales technical and other literature issued by the Company may be relied upon to be accurate in the exact circumstances in which it is expressed otherwise any illustrations performance details examples of installations and methods of assembly and all other information and data in such literature are based on experience and upon trials under test conditions and are provided for general guidance only. No such information or data shall form part of the contract unless it is specifically referred to in the quotation or order acknowledgement or the Customer shall have complied in respect thereof with Clause 1.3.

TERMINATION

16.1 Without prejudice to any other rights or remedies of the Company it shall be entitled in any of the following circumstances to terminate (in whole or in part) this and any other contract whenever made between the Company and the Customer and/or to suspend deliveries and/or to receive upon demand payment of all monies payable under any such contracts whether or not otherwise due:

16.1.1 The Customer made or proposes any voluntary arrangement with its creditors or becomes subject to an administration order or becomes bankrupt or goes into liquidation;

16.1.2 An encumbrance takes possession or a receiver is appointed of any of the property or assets of the Customer;

16.1.3 The Customer becomes unable to satisfy its debts as they fall due or cease, or threatens to cease to carry on business;

16.1.4 The Company reasonably believes that any of the events mentioned above or any equivalent or similar event under any relevant laws to which the Customer or any connected person is subject has or may occur;

16.1.5 The Customer or any connected person commits any breach of this or any other contract whenever made between the Customer and the Company.

FORCE MAJEURE

17.1 The Company shall be excused performance of its obligations whilst and if affected by act of God governmental restriction condition or control, any act done or not done pursuant to a trade dispute whether such dispute involves its employees or not, default by suppliers of the Company, shortage of materials or by any other act matter or thing beyond its reasonable control including failure by the other party to carry out anything required for performance of the contract.

17.2 In the event that the Company does not perform its obligations by reason of any of the causes referred to in Clause 17.1 within six months after the time for performance then the Company may by written notice terminate the contract without liability save that the Customer shall pay for any Products delivered or completed at the time of termination.

TOOLS

18 Any tools (such as jigs, dies, etc) which the Company may construct or acquire specifically in connection with the Products shall, notwithstanding any charges the Company may make for them, be and remain the Company's sole and unencumbered property and in the Company's possession and control without restriction.

FREE-ISSUE MATERIALS

19.1 Free-issue material shall be insured by and remain at the risk of the Customer at all times and the Company shall be indemnified by the Customer against any loss damage injury or expense whatsoever arising directly or indirectly therefrom and the company shall not be liable for loss of or damage to any such materials during fabrication by the Company or sub-contractor employed by the Company or whilst on the premises of the Company or of any sub-contractor in or transit to or from the premises of the Company or of any such sub-contractor provided that the Company may at its sole discretion make a contribution towards the replacement costs of such materials.

19.2 An allowance for material lost on process scrap is (where applicable) included in the contract price and no such losses shall be the subject of any claim by the Customer or contribution by the Company.

19.3 Where materials are supplied by or on behalf of the Customer to the Company the Customer shall be responsible to ensure that the material is of satisfactory quality and is fit for its purpose and shall indemnify the Company against any loss damage injury or expenses whatsoever arising directly or indirectly from any fault in or incorrect specification of the said materials.

CONSUMER PROTECTION ACT 1987

20.1 Where the Customer purchases the Products for use or incorporation with any composite products to be assembled produced processed packed or supplied by the Customer or for resale or supply ancillary to any such composite products or other products supplied by the Customer then:

20.1.1 The Customer shall forthwith on demand produce for inspection by the Company copies of all written instructions information and warnings to be supplied by the Customer in relation thereto provided nevertheless that such inspection or right to inspect shall not give rise to any responsibility or liability on the part of the Company; and

20.1.2 The Customer shall indemnify the Company against any losses costs and damages that the Company may suffer or incur in the event any claim is made against the Company in relation thereto if the Products did not comprise the defective element thereof or were rendered defective by reason of actions or omissions of the Customer (including without limitation the supply of defective free-issue materials) or were rendered defective by reason of instructions or warnings given or omitted by the Customer or other reseller.

20.2 For the purpose of Clause 20.1 the term "defective" shall be interpreted in accordance with the definition contained in Part 1 of the Consumer Protection Act 1987.

HEALTH & SAFETY

21 The Customer agrees to pay due regard to any information supplied by the Company relating to the use for which the Products are designed or have been tested or concerning conditions necessary to ensure that they will be safe and without risk to health at all times when they are being set, used, cleaned, serviced or maintained by any person and the Customer undertakes to take such steps as may be specified by such information or otherwise necessary to ensure that as far as is reasonably practicable the Products will be safe and without risk to health at all times as mentioned above.

LAW AND JURISDICTION ETC

21.1 The Contract shall be governed and interpreted exclusively according to the Laws of England. The parties hereby agree to submit to the exclusive jurisdiction of the English courts provided that the Company may at its option take proceedings in the courts of the state in which the Customer is domiciled including action to obtain any remedy (including injunctive relief). In the case of any order for the export of Products, the Schedule to the Uniform Law on International Sales Act 1967 shall not in any circumstances apply to the Contract and neither shall the limits imposed by the Unfair Contract Terms Act 1977 on the extent to which liability can be excluded or limited.

21.2 No waiver of or delay or failure by the Company to exercise any rights or remedies shall prejudice or preclude any future or further exercise thereof.

21.3 If any provision of these conditions shall be held invalid or unenforceable in whole or in part then the unaffected provisions shall remain in full force and effect. Headings appear for convenience only and shall not affect the Construction of these conditions.

22.1 If the Contract includes the supply of services and no general conditions of the company relating specifically to the supply of services are made applicable to such services then these conditions shall mutatis mutandis apply to such services as they would apply to Products and in such event Clause 10.1 will be deemed to include a reference to Sections 3 to 5 of the Supply of Goods and Services Act 1982 (as amended), either in addition to or in place of the reference to Sections 13 to 15 of the Sale of Goods Act 1979 (as amended) as may be appropriate. For the avoidance of doubt the following provisions apply where the Company supplies services to the Customer in accordance with Clause 22.4.

22.4.1 The Company's obligation to provide the services is in any event conditional upon payment of the agreed price for the services. Any default or delay in payment according to the terms agreed between the Company and the Customer shall entitle the Company at its option to decline to perform or decline to continue to perform its obligations hereunder but without thereby incurring any liability to the Customer.

22.4.2 Save to the extent that by reason of negligence on the part of the Company in the performance of the services which results in death or personal injury (which the Company does not limit or exclude) the Company's liability under the contract shall be limited to the amount of charges paid to the Company in return for the services and in particular the Company accepts responsibility only for direct and unavoidable loss or damage arising from any negligence in the provision of services and in particular all other types of loss whether economic, financial, indirect or consequential and whether reasonably foreseeable or not are excluded to the fullest extent permitted by law.

22.4.3 The Customer shall lend all such reasonable assistance to the Company in the performance of the services as the Company shall reasonably require.

22.4.4 The Customer shall indemnify and keep the Company, its employees, agents and contractors indemnified at all times from and against any loss or damage or injury caused to persons or property in the course of the provision of the services where such loss or damage arises by reason of the Customer's negligence or negligence of persons under the control of the Customer.

22.4.5 The company acknowledges and agrees that if due to the act or omission of the Customer, the company is not able, having attended at the Customer's premises to perform the services, the Company shall be entitled to claim reasonable additional costs and expenses from the Customer occasioned by any resulting delay in the provision of the services.

22.5 In cases for the sale or supply of Products overseas, the following additional provisions shall apply unless otherwise stipulated in writing by the Company:

22.5.1 The Customer shall be solely responsible for obtaining all necessary import authorisations, the payment of any applicable import taxes, duties or imposts and the Company shall be under no obligation to give the Customer the notice specified in Section 32(3) of the Sale of Goods Act 1979 (or any re-enactment thereof).

22.5.2 Quotations issued in a currency other than Sterling may at the

Company's option, unless otherwise agreed in Writing, be subject to amendment in the event of fluctuations in the applicable exchange rate prior to the date of invoice;

22.5.3 Payment in respect of Products for export is due on the date specified by the Company at the date when the Contract is made, in the currency stated in the invoice and in accordance with the method of payment stipulated by the Company. All costs incurred by the Company in connection with the designated particular method of payment shall be met by the customer.

ORDERS & INFORMATION

POLYPIPE CIVILS DIVISION

Polypipe Civils Limited Head Office
Union Works, Bishop Meadow Road, Loughborough, Leicestershire, LE11 5RE
Tel: 01509 615100 Fax: 01509 610215

POLYPIPE CIVILS LTD SALES OFFICE

Tel: 01509 615102 London / Home Counties / East Anglia
Tel: 01509 615110 Utilities / North West / North East / Ireland
Tel: 01509 615133 Scotland
Tel: 01509 615125 South West / Midlands / Wales
Tel: 01509 615101 Customer Care
Tel: 01509 615150 Technical Support line
Fax: 01509 615205 Technical Fax line
Tel: 01509 615126 Estimating
Fax: 01509 615153 Estimating Fax line

Fax sales enquiries and orders to: 01509 265945
E-mail sales enquiries: sales@polypipецivils.co.uk

POLYPIPE CIVILS LTD SALES OFFICE - SCOTLAND

2410 London Road, Mount Vernon, Glasgow, G32 8XZ
Tel: 0141 778 8822 Fax: 0141 778 2703

HYDROTUB POLYPIPE S.A.S

Z.A. des Sablons, 13 Chemin des Petits Eboulis - 77230 Dammartin en Goële,
France
Tel: (00 33) 1 64 02 52 42 Fax: (00 33) 1 64 02 54 34

POLYPIPE GROUP HEAD OFFICE

Broomhouse Lane, Edlington, Doncaster, DN12 1ES
Tel: 01709 770000 Fax: 01709 770001



enquiries@polypipецivils.co.uk
www.polypipецivils.co.uk



© Polypipe Civils Limited
All rights reserved. Copyright in this publication belongs to Polypipe Civils Limited and all such copyright may not be used, sold, copied or reproduced in a whole or part in any manner or in any media to any person without our prior written consent.



006225, FM11944, FM318